

N: 73455.288

E: 710386.673

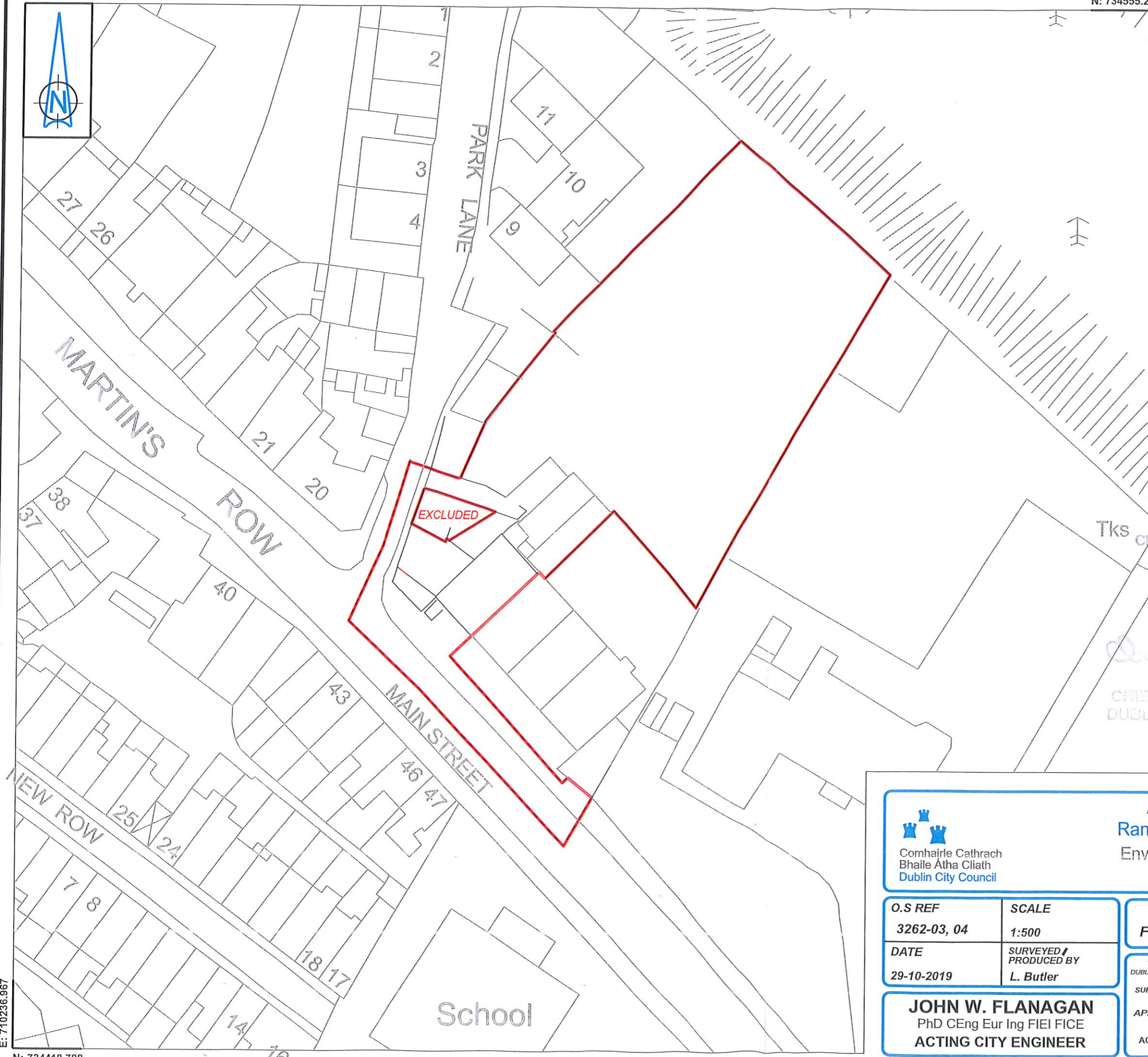
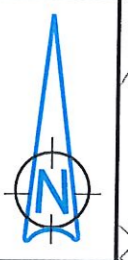

**MAIN STREET, CHAPELIZOD AREA,
COMPULSORY PURCHASE
(RESIDENTIAL/COMMERCIAL
DEVELOPMENT), ORDER
2018**

Map referred to in Vesting Order Serial
No. 2020/1

Total area to be vested =
2259.1m²

Alamy
Reference numbers 1 - 8

CIVIC OFFICES
DUBLIN
CITY COUNCIL OFFICIAL

EF

John P. Keegan

CHIEF EXECUTIVE OF
DUBLIN CITY COUNCIL

*not to scale when printed from PDF.



Comhairle Cathrach
Bhaile Átha Cliath
Dublin City Council

An Roinn Comhshaoil agus Iompair
Rannán Suirbhéireachta agus Léarscáilithe
Environment and Transportation Department
Survey and Mapping Division

| | |
|------------------------|--|
| O.S REF 3262-03, 04 | SCALE 1:500 |
| DATE 29-10-2019 | SURVEYED / PRODUCED BY L. Butler |

| | | | | |
|----------|---------------------------------------|------|--------|-----|
| INDEX No | FOLDER No | CODE | DWG No | REV |
| FILE NO | SM-2019-1147- 0204 - C2 - 001 - A.dgn | | | |

JOHN W. FLANAGAN
PhD CEng Eur Ing FIEI FICE
ACTING CITY ENGINEER

THIS MAP IS CERTIFIED TO BE COMPUTER GENERATED BY
DUBLIN CITY COUNCIL FROM ORDNANCE SURVEY DIGITAL MAPBASE
SURVEY, MAPPING AND RELATED RESEARCH APPROVED
APPROVED *Thomas Curran 13/11/2019*
THOMAS CURRAN
ACTING MANAGER LAND SURVEYING & MAPPING
DUBLIN CITY COUNCIL

INDEX No.
SM-2019-1147

E: 710236.967

N: 734418.788