

N: 739141.158

E: 719921.249

E: 719735.746

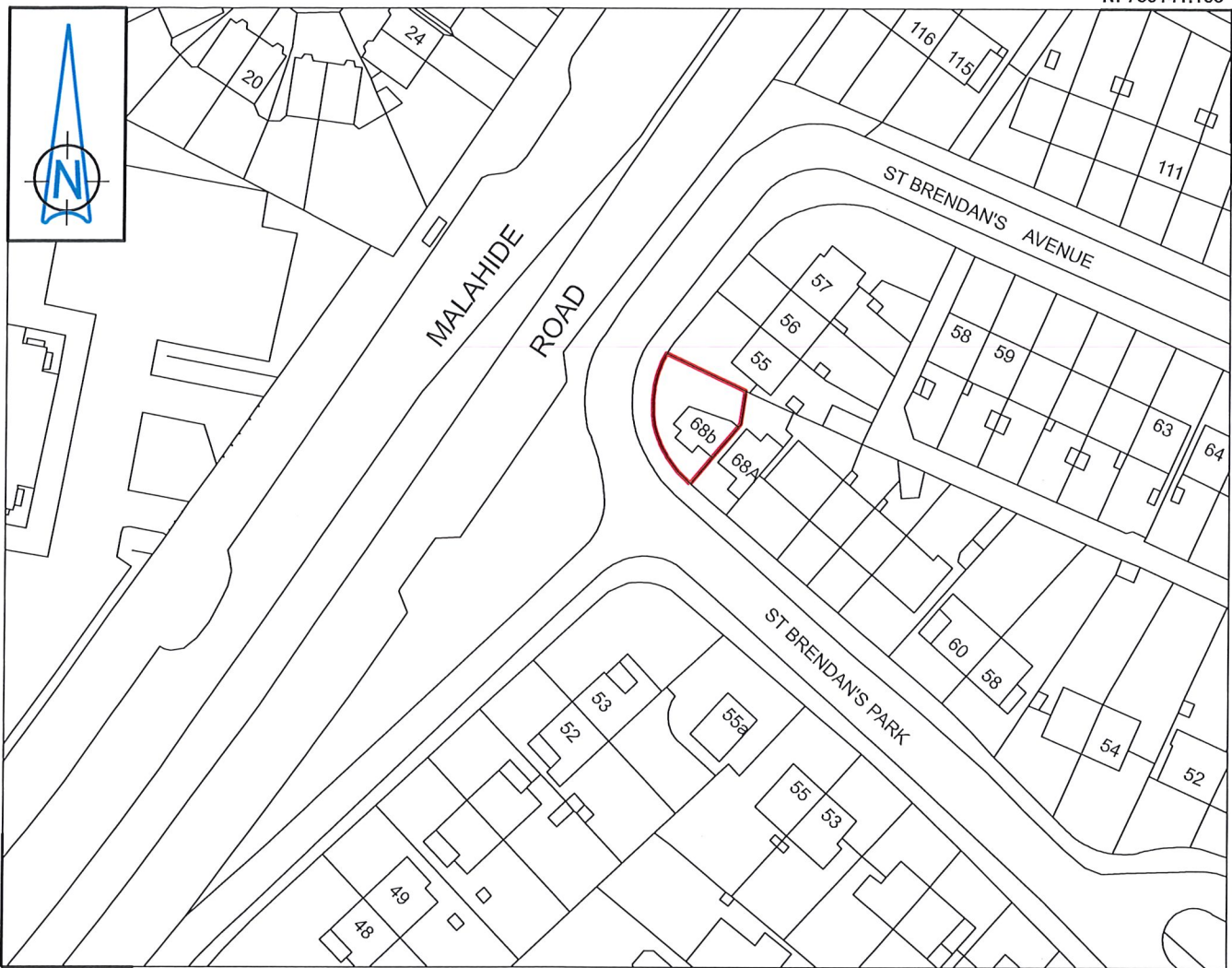

N: 738997.222

### 68B ST. BRENDAN'S PARK

Area: 171.6m<sup>2</sup> DS795

Map Referred to Vesting Order made on the 7<sup>th</sup> day of April 2022 by Dublin City Council under section 17 of the Derelict Sites Act 1990, as amended by the Planning and Development Act 2000



Comhairle Cathrach  
Bhaile Átha Cliath  
Dublin City Council

An Roinn Comhshaoil agus Iompair  
Rannán Suirbhéireachta agus Léarscáilithe  
Environment and Transportation Department  
Survey and Mapping Division

O.S REF  
3132-20

SCALE  
1:1000

FILE NO F:\SM-2022-0066 - 001 - B.dgn

INDEX No DWG No REV

DATE  
09-02-2022

SURVEYED /  
PRODUCED BY  
L. Butler

THIS MAP IS CERTIFIED TO BE COMPUTER GENERATED BY  
DUBLIN CITY COUNCIL FROM ORDNANCE SURVEY DIGITAL MAPBASE  
SURVEY, MAPPING AND RELATED RESEARCH APPROVED

**Dr JOHN W. FLANAGAN**  
CEng FIEI FICE  
CITY ENGINEER

APPROVED \_\_\_\_\_  
**THOMAS CURRAN**  
ACTING MANAGER LAND SURVEYING & MAPPING  
DUBLIN CITY COUNCIL

**INDEX No.**  
**SM-2022-0066**