

**KEY:**

- PROPOSED CARRIAGEWAY RESURFACING
- PROPOSED ISLAND / FOOTWAY
- PROPOSED BUILDOUT
- PROPOSED NATURAL STONE-PAVED FOOTWAY
- PROPOSED CYCLE PROTECTION ISLANDS
- PROPOSED GREY RESIN BOUND AGGREGATE
- PROPOSED RAISED TABLE
- PROPOSED KERB FLUSH WITH CARRIAGEWAY
- PROPOSED DROP KERB
- PROPOSED FULL HEIGHT SEGREGATION KERB
- PROPOSED ISLAND WITH UNCONTROLLED PEDESTRIAN CROSSING
- PROPOSED CYCLE TRACK RAMP
- PROPOSED BLISTER TACTILE FOR CONTROLLED CROSSINGS
- PROPOSED TACTILE FOR UNCONTROLLED CROSSINGS
- LANDS MADE AVAILABLE

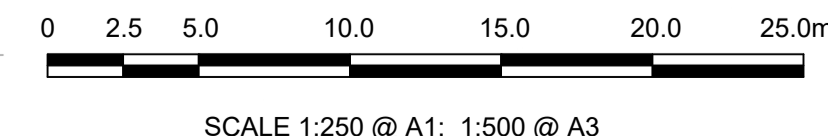
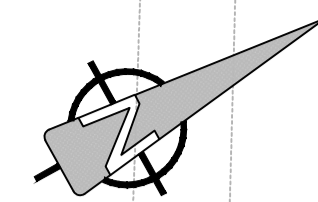
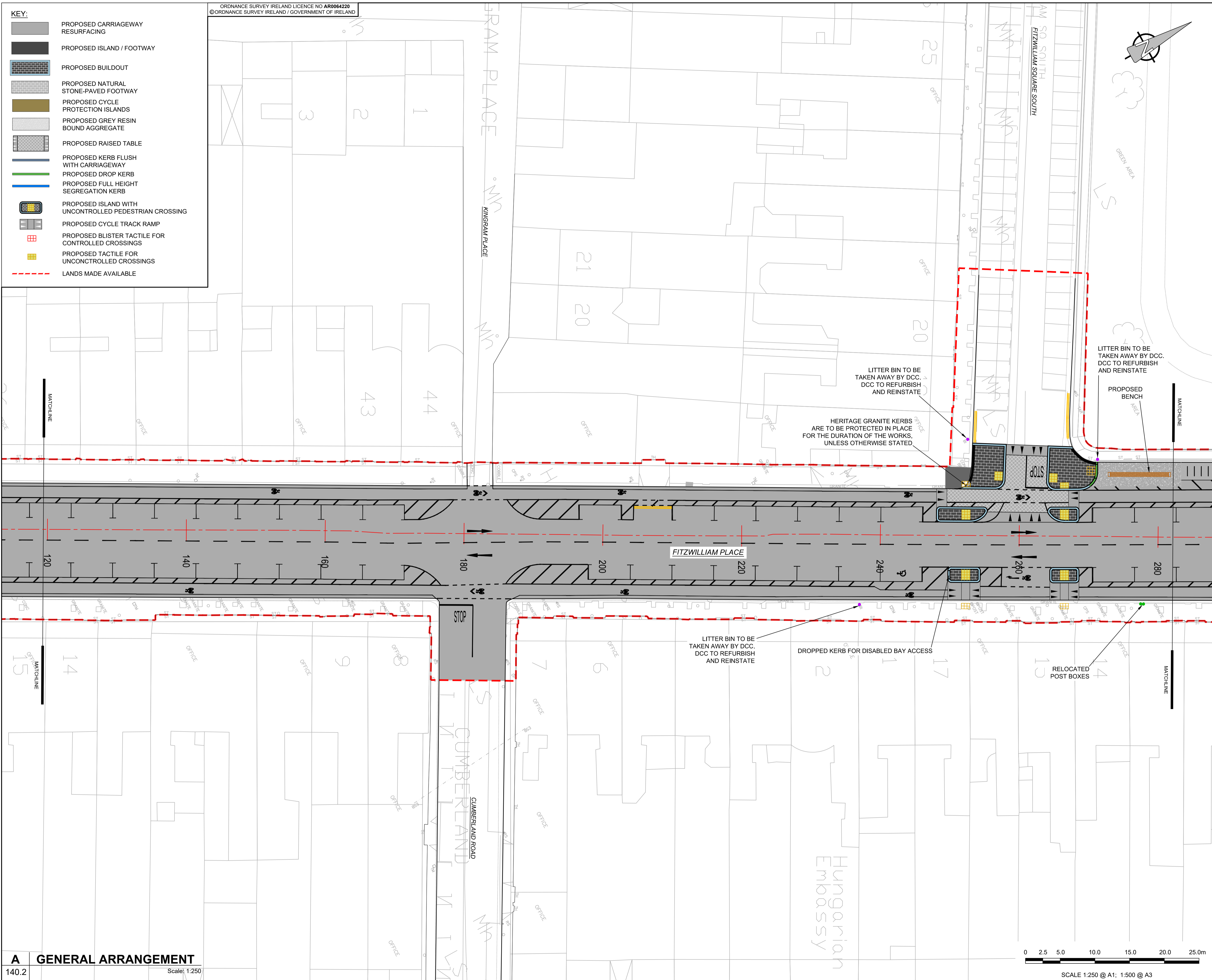

This drawing has been prepared for the use of AECOM's client. It may not be used, modified, reproduced or relied upon by third parties, except as agreed by AECOM or as required by law. AECOM accepts no responsibility, and denies any liability, whatsoever, to any party that uses or relies on this drawing without AECOM's express written consent. All measurements must be obtained from the stated dimensions.

**AECOM**

**PROJECT**  
Fitzwilliam Cycle Route

**CLIENT**  
Comhairle Cathrach  
Bhaile Átha Cliath  
Dublin City Council

**NTA**  
Údarás Náisiúnta Iompair  
National Transport Authority

**Project Ireland 2040**  
Building Ireland's Future

**CONSULTANT**  
AECOM  
Adelphi Plaza  
George's Street Upper  
Dun Laoghaire Co. Dublin  
Tel: +353(0)1 2383100 Fax: +353(0)1 2383199  
www.aecom.com

- NOTES:**
- THIS DRAWING IS TO BE READ IN CONJUNCTION WITH ALL OTHER RELEVANT ARCHITECTURAL AND ENGINEERING DRAWINGS. ANY DISCREPANCIES, ERRORS OR OMISSIONS TO BE BROUGHT TO THE ATTENTION OF THE DESIGNER.
  - ALL DIMENSIONS TO BE CHECKED BY THE CONTRACTOR ON SITE PRIOR TO COMMENCEMENT OF WORKS.
  - AECOM LIMITED TO BE INFORMED BY THE CONTRACTOR OF ANY DISCREPANCIES PRIOR TO THE COMMENCEMENT OF WORKS ON SITE.
  - DIMENSIONS OF ALL BOUNDARIES AND ADJOINING ROADS TO BE CHECKED ON SITE PRIOR TO COMMENCEMENT OF WORKS.
  - DO NOT SCALE. ALL MEASUREMENTS AND COORDINATES TO BE CHECKED ON SITE.

**ISSUE/REVISION**

A/R	DATE	DESCRIPTION
A	JUNE 2022	ISSUED FOR TENDER

**KEY PLAN**

**PROJECT NUMBER**  
60578028

**SHEET TITLE**  
GENERAL ARRANGEMENT  
SHEET 2 OF 6

**SHEET NUMBER**  
60578028\_DD\_SHT\_140.2