

LAYOUT G

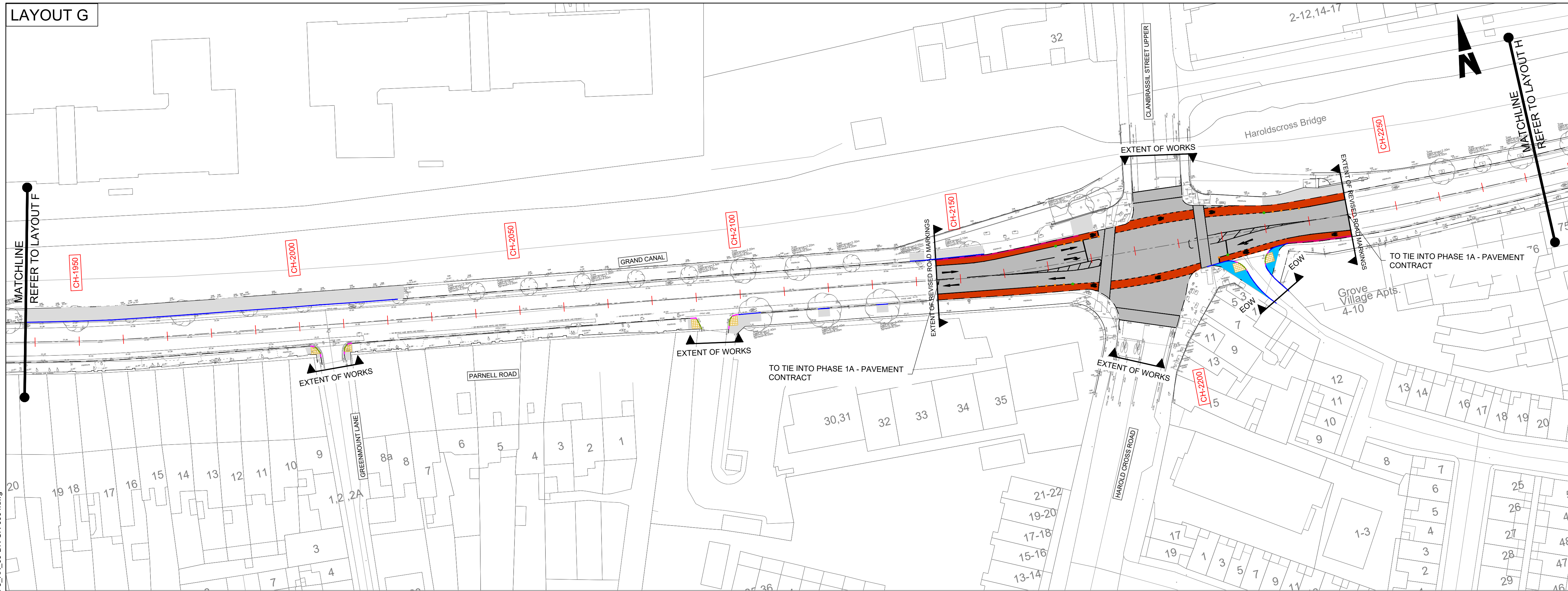

LAYOUT H



- ORDNANCE SURVEY IRELAND LICENCE NO CYAL50217544  
©ORDNANCE SURVEY IRELAND / GOVERNMENT OF IRELAND
- NOTES:
- THIS DRAWING IS TO BE READ IN CONJUNCTION WITH ALL OTHER RELEVANT ENGINEERING DRAWINGS. ANY DISCREPANCIES, ERRORS OR OMISSIONS TO BE BROUGHT TO THE ATTENTION OF THE EMPLOYER.
  - EMPLOYERS REP TO BE INFORMED BY THE CONTRACTOR OF ANY DISCREPANCIES PRIOR TO THE COMMENCEMENT OF WORKS ON SITE.
  - ALL BOUNDARIES AND ADJOINING ROADS TO BE CHECKED ON SITE PRIOR TO COMMENCEMENT OF WORKS.
  - DO NOT SCALE FROM THIS DRAWING.
  - DESIGNS SUBJECT TO ARBORICULTURAL ASSESSMENTS
  - UPDATED SIGNAL STAGING TO BE AGREED WITH DUBLIN CITY COUNCIL
  - REFER TO PROPOSED CROSS-SECTIONS FOR DETAILS OF PROPOSED CROSSFALLS AND CROWN LINE DEVIATION

- LEGEND:
- EXISTING KERB TO BE MAINTAINED
  - EXISTING KERB TO BE REMOVED
  - EXISTING MASTIC DRAINAGE CHANNELS TO BE REPLACED WITH MASTIC CHANNEL MA 10 PMB 65/105-60.
  - PROPOSED MASTIC DRAINAGE CHANNELS TO BE REPLACED WITH MASTIC CHANNEL MA 10 PMB 65/105-60.
  - PROPOSED CYCLE TRACK. REFER TO DCC CONSTRUCTION STANDARDS FOR ROAD AND STREET WORKS SECTION 10.1 FOR DETAILS.
  - PROPOSED BUILDOUTS. SEE DRAWING SERIES DCC18009-NTA-PAV\_HS-S01c-2\_XX\_00-DR-CR-0005 FOR DETAILS
  - PROPOSED FOOTWAY. IN ACCORDANCE TO DCC CONSTRUCTION STANDARDS FOR ROAD AND STREET WORKS SECTION 5.3
  - PROPOSED CARRIAGEWAY. SEE DRAWING SERIES DCC18009-NTA-PAV\_PV-S01c-2\_XX\_00-DR-CR-0001 - 0006 FOR DETAILS
  - PROPOSED 125mm KERB TO DCC CONSTRUCTION STANDARDS FOR ROAD AND STREET WORKS DETAIL RM002
  - PROPOSED TRANSITION KERB TO DCC CONSTRUCTION STANDARDS FOR ROAD AND STREET WORKS DETAIL RM002
  - PROPOSED 0 TO 6mm KERB TO DCC CONSTRUCTION STANDARDS FOR ROAD AND STREET WORKS DETAIL RM002
  - PROPOSED 25mm DRIVEWAY ACCESS AS PER DCC CONSTRUCTION STANDARDS FOR ROAD AND STREET WORKS
  - FLEXIBLE BOLLARD TYPE A AS PER DCC20009-NTA-SCD\_ZZ-S01c\_XX\_00-DR-KK-0001 - DETAIL A
  - FLEXIBLE BOLLARD TYPE B AS PER DCC20009-NTA-SCD\_ZZ-S01c\_XX\_00-DR-KK-0001 - DETAIL A
  - RED TACTILE PAVING AS PER DCC20009-NTA-SCD\_ZZ-S01c\_XX\_00-DR-KK-0001 - DETAIL B
  - BUFF TACTILE PAVING AS PER DCC20009-NTA-SCD\_ZZ-S01c\_XX\_00-DR-KK-0001 - DETAIL B
  - BUFF TACTILE PAVING AS PER DCC20009-NTA-SCD\_ZZ-S01c\_XX\_00-DR-KK-0001 - DETAIL D

FOR CONSTRUCTION

NOTE:

ALL EXISTING ROAD LEVELS, DRAINAGE CHANNEL LEVELS, WIDTHS, GRADIENTS AND KERB LEVELS TO BE MAINTAINED ALONG SCHEME EXTENTS.

CONTRACTOR TO UNDERTAKE INDEPENDENT TOPOGRAPHICAL SURVEY AND PUT IN PLACE CONTROLS TO ENSURE ALL LEVELS INCLUDING MASTIC CHANNEL ARE CONSTRUCTED TO MATCH EXISTING

AVAILABLE UTILITY INFORMATION SUGGESTS THE PRESENCE OF GAS TRANSMISSION MAINS, HIGH VOLTAGE CABLES, AND OTHER UTILITY SERVICES AT ALL SECTIONS

CONTRACTOR IS TO CONTACT ALL RELEVANT UTILITY COMPANIES TO CONFIRM TYPE AND LOCATION OF ALL EXISTING SERVICES PRIOR TO COMMENCEMENT OF ANY CONSTRUCTION WORKS

**Disclaimer**

a. © National Transport Authority (NTA) 2022. This drawing is confidential and the copyright in it is owned by NTA. This drawing must not be either loaned, copied or otherwise reproduced in whole or in part or used for any purpose without the prior permission of NTA.

b. This drawing is to be used for the design element identified in the titleblock. Other information shown is to be considered indicative only. The drawing is to be read in conjunction with all other relevant design drawings.

c. D.S. data used for plans are printed under © Ordnance Survey Ireland Government of Ireland. All rights reserved. Licence Number EN 0082119 National Transport Authority. All elevations are in metres and relate to OSi Geoid Model (OSGM15) Mean Head. All Co-ordinates are in Irish Transverse Mercator Grid (ITM) as defined by OSi active local GPS station.

d. Information concerning the position of apparatus shown on this drawing is based on drawings supplied by the utility owners and/or the utility works contractor, whilst every care has been taken in the preparation of this drawing, positions should be taken as approximate and are intended for general guidance only and no representation is made by the NTA as to the accuracy, completeness, sufficiency or otherwise of this information or any matter on which the information is based (including but not limited to loss or damage arising as a result of reliance by recipients on the information or any part of it). Any liabilities are hereby expressly disclaimed.

e. The information contained herein has been provided by the NTA but does not purport to be comprehensive or final. Recipients should not rely on the information. Neither the NTA nor any of its directors, officers, employees, agents, stakeholders or advisers make any representation or warranty as to, or accept any liability or responsibility in relation to, the adequacy, accuracy, reasonableness or completeness of the information provided as part of this document or any matter on which the information is based (including but not limited to loss or damage arising as a result of reliance by recipients on the information or any part of it). Any liabilities are hereby expressly disclaimed.

Rev	Date	Drn	Chk'd	App'd	Description
C01	13.05.2022	RH	NG	MD	ISSUED FOR CONSTRUCTION

Client: **NTA**  
Údarás Náisiúnta Iompair  
National Transport Authority

Engineering Designer: **CYCLING DESIGN OFFICE**

Date: 13.05.2022  
Scale: 1:500@A1  
1:1000@A3

Project Code: DCC18009  
Originator Code: NTA

Drawn: RH  
Checked: NG  
Approved: MD

QMS Code: S01C

Project Title: <b>SOUTH GRAND CANAL SAFETY IMPROVEMENTS SCHEME 2A CIVILS AND JUNCTIONS</b>			
Drawing Title: <b>GENERAL ARRANGEMENT SUIR ROAD TO LEESON STREET</b>			
Drawing File Name: DCC18009-NTA-SLW_ZZ-S01c-3_XX_00-DR-CR-0004	Sheet Number: 4 of 6	Status: F10	Rev: C01

DO NOT SCALE USE FIGURED DIMENSIONS ONLY