

**CLONTARF TO CITY CENTRE PROJECT  
SECTIONS 3 - STAGE 2**

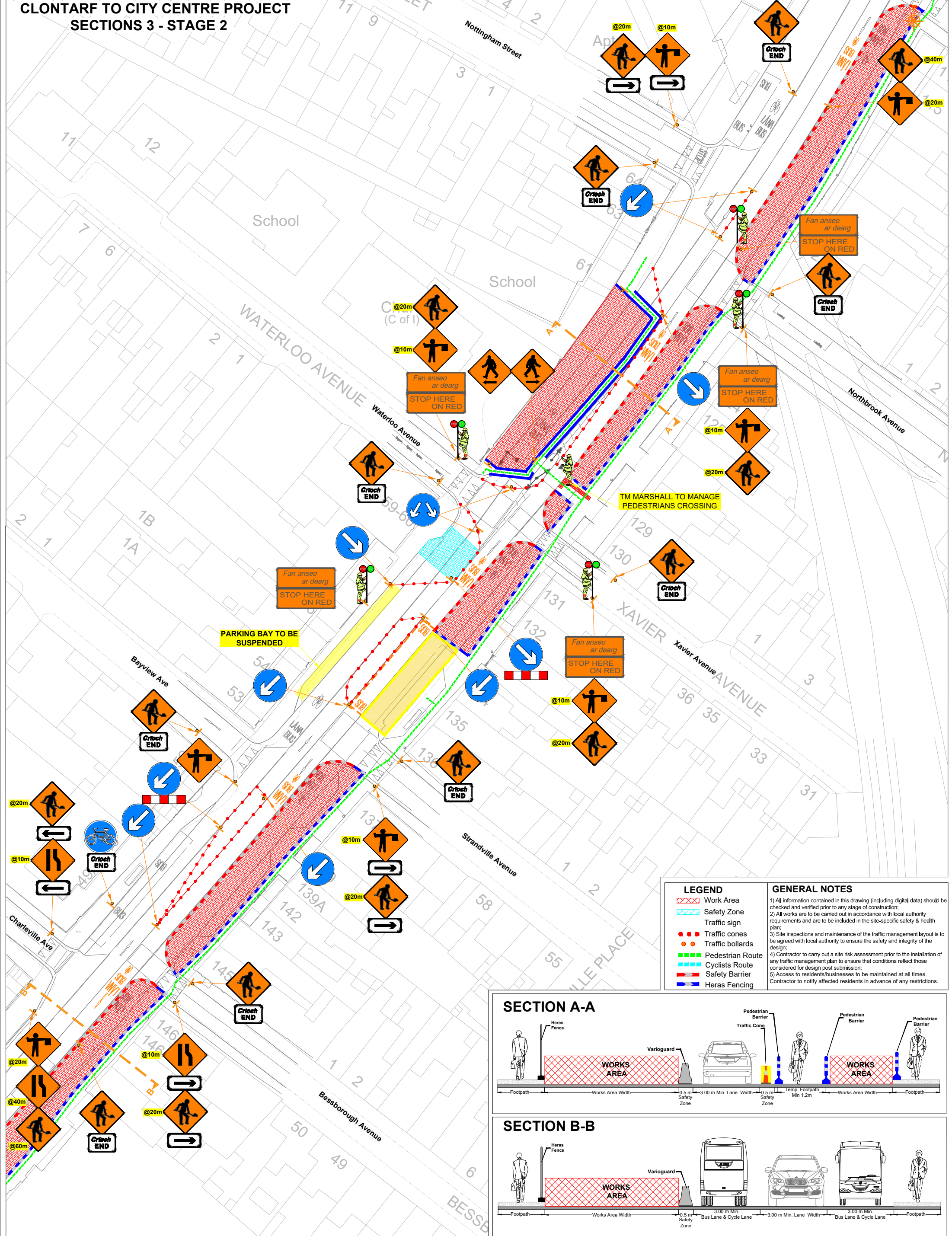

LEGEND	GENERAL NOTES
Work Area	1) All information contained in this drawing (including digital data) should be checked and verified prior to any stage of construction;
Safety Zone	2) All works are to be carried out in accordance with local authority requirements and are to be included in the site-specific safety & health plan;
Traffic sign	3) Site inspections and maintenance of the traffic management layout is to be agreed with local authority to ensure the safety and integrity of the design;
Traffic cones	4) Contractor to carry out a site risk assessment prior to the installation of any traffic management plan to ensure that conditions reflect those considered for design post submission;
Traffic bollards	5) Access to residents/businesses to be maintained at all times. Contractor to notify affected residents in advance of any restrictions.
Pedestrian Route	
Cyclists Route	
Safety Barrier	
Heras Fencing	

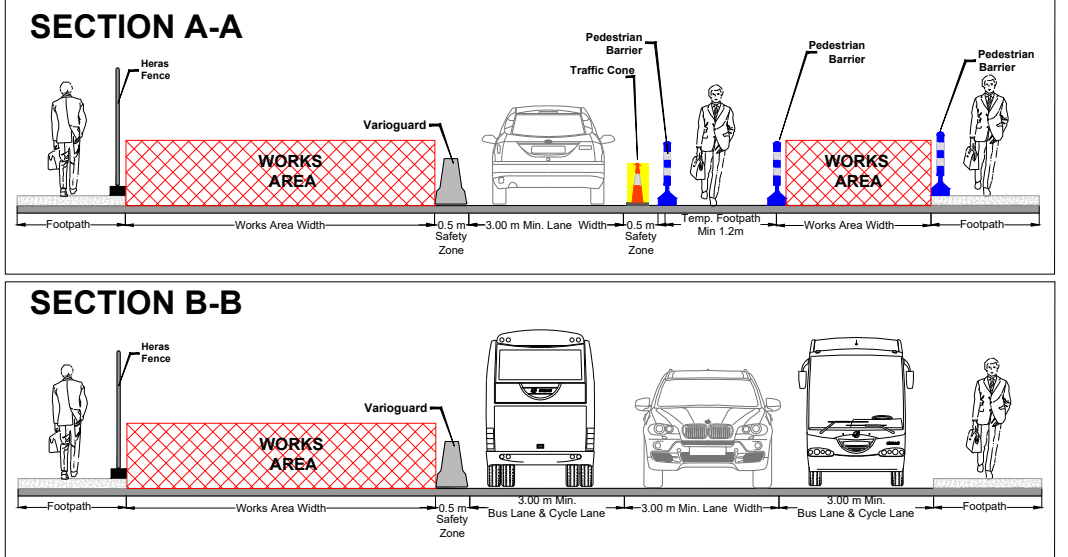

**ROAD CONTROL**

Copyright Notes:  
This drawing is the property of Road Control Services Ltd. The design information contained herein is strictly confidential. This document is not to be used, reproduced, disclosed or circulated in whole or in part without prior written consent.

**CLIENT**

**CLONMEL ENTERPRISES**  
BUILDING & CIVIL ENGINEERING

DESIGN PARAMETERS	
Speed Limit	60
Road Classification	1(iv)
Roadworks type	A
Number of advance signs	3
Sign visibility	60m
Distance between signs	20m
Taper at lane	1 in 10
Taper at hard shoulder	N/A
Sign size (diamond)	600mm
Sign size (circular)	600mm
Minimum Cone size	750mm
Cone spacing at tapers	3m
Cone spacing longitudinal	6m
Lateral Safety Zone	0.5m
Longitudinal Safety Zone	15m
Minimum lane width	3.0m

Rev	Date	Details	Drn	Chk	App	Drn	DJ	Project
								CLONTARF TO CITY CENTRE PROJECT
							Chk DS	TRAFFIC MANAGEMENT PLAN SECTION 3 ROAD CROSSING XAVIER AVENUE_STAGE 2
							App DH	
							Date 18/10/2022	
							Scale A1 NTS A3 NTS	Title
							Stage CONSTRUCTION	Drawing No C22001_00_062B

**CLONTARF TO CITY CENTRE PROJECT**

**TRAFFIC MANAGEMENT PLAN SECTION 3 ROAD CROSSING XAVIER AVENUE\_STAGE 2**

Drawing No C22001\_00\_062B Rev 0