

CLONTARF TO CITY CENTRE PROJECT

SECTION 7_TRAFFIC SIGNALS WORKS

STAGE 2

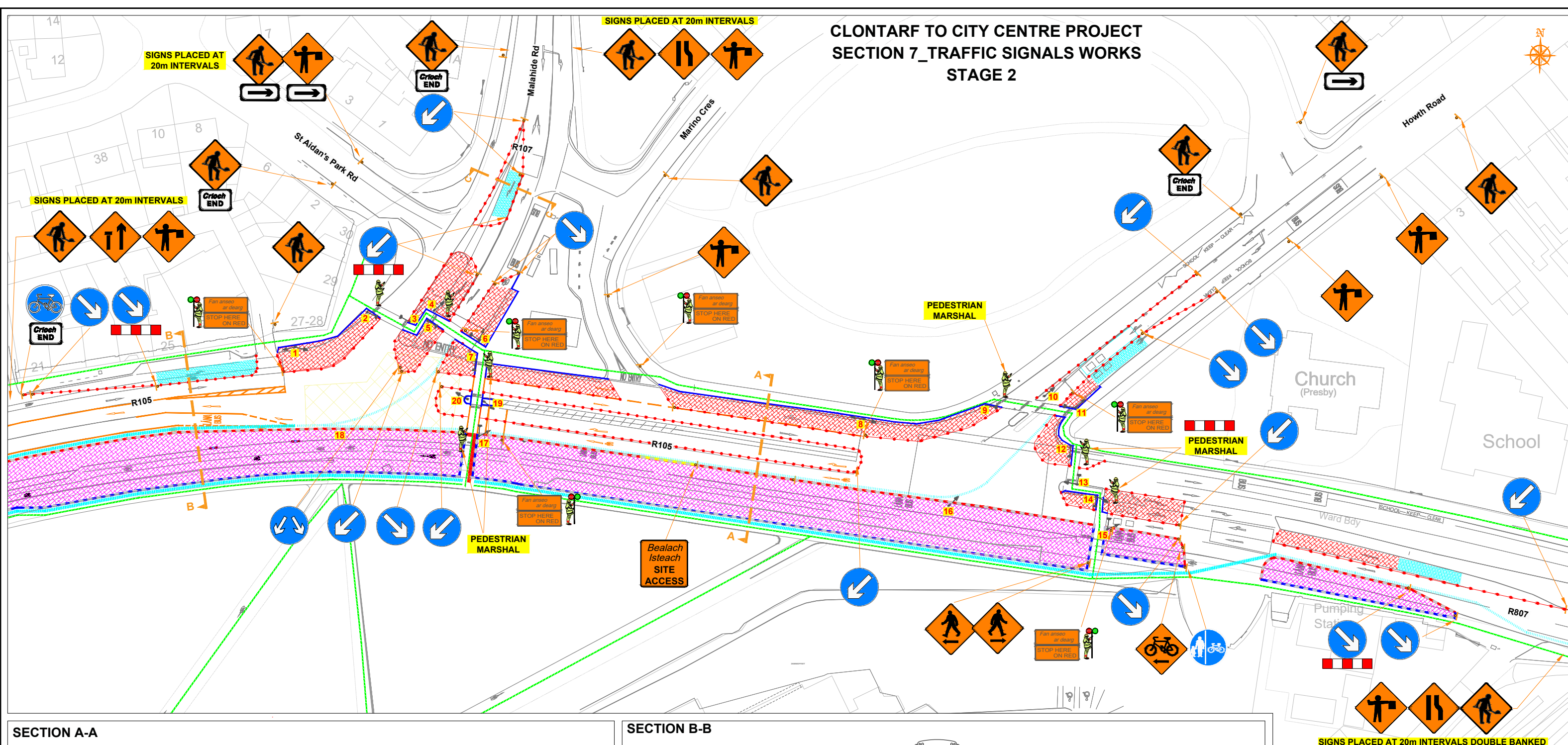

SIGNS PLACED AT 20m INTERVALS DOUBLE BANKED

SECTION A-A

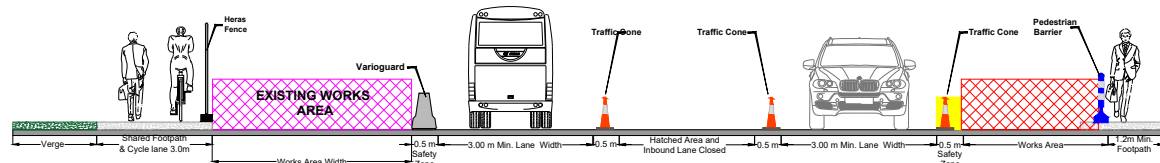

SECTION B-B

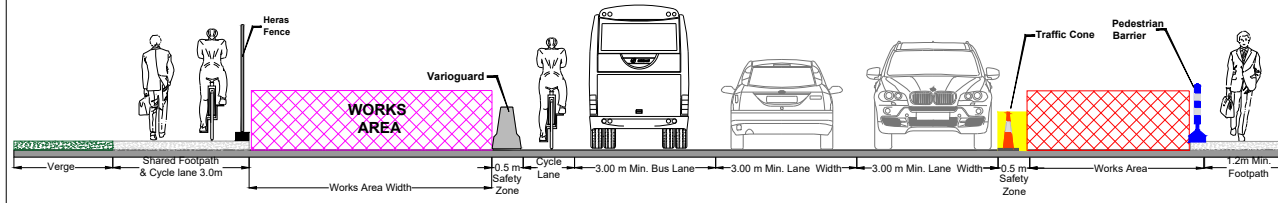
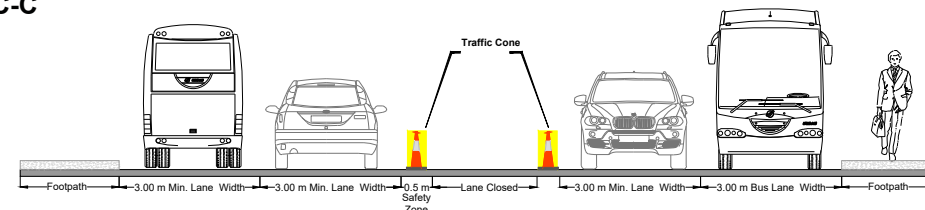
**SECTION C-C**

SITE NOTES

- 1) Advance signs to be placed on all approaches to works.
- 2) Exact sign position to be determined on site. Conflicting permanent signs to be obscured for duration of works.
- 3) Exact site access/egress to be determined on site and signed accordingly.
- 4) The optimum lane width for all classes of vehicles is 3.3m. this may be reduced to a minimum of 3m. below this, HGV's and buses must be marshaled past the works. The absolute minimum lane width, if only cars and light vehicles are present, is 2.5m.
- 5) TTM operative present on-site to coordinate safe site entrance/exit, safe crossing of pedestrians by implementing an all stop when required.
- 6) All works to be carried out in accordance with Chapter 8 of the Traffic Signs Manual (2019 Edition) and Temporary Traffic Management Operations Guidance 2019.
- 7) Access to residents/businesses to be maintained at all times. Contractor to notify affected residents in advance of any restrictions.



ROAD CONTROL

Copyright Notes:
This drawing is the property of Road Control Services Ltd. The design information contained herein is strictly confidential. This document is not to be used, reproduced, disclosed or circulated in whole or in part without prior written consent.

CLIENT











CLONMEL
ENTERPRISES
BUILDING & CIVIL ENGINEERING

DESIGN PARAMETERS

Speed Limit	60
Road Classification	1(iv)
Roadworks type	B
Number of advance signs	3
Sign visibility	60m
Distance between signs	20m
Taper at lane	1 in 10
Taper at hard shoulder	N/A

Sign size (diamond)	600mm
Sign size (circular)	600mm
Minimum Cone size	750mm
Cone spacing at tapers	3m
Cone spacing longitudinal	6m
Lateral Safety Zone	0.5m
Longitudinal Safety Zone	15m
Minimum lane width	3.0m

LEGEND

-  Existing Work Area
-  Extended Work Area
-  Traffic sign
-  Traffic cones
-  Pedestrian Route
-  Varioguard
-  Heras Fencing
-  Pedestrians Barrier
-  Temp. Line Markings

GENERAL NOTES

- 1) All information contained in this drawing (including digital data) should be checked and verified prior to any stage of construction;
- 2) All works are to be carried out in accordance with local authority requirements and are to be included in the site-specific safety & health plan;
- 3) Site inspections and maintenance of the traffic management layout is to be agreed with local authority to ensure the safety and integrity of the design;
- 4) Contractor to carry out a site risk assessment prior to the installation of any traffic management plan to ensure that conditions reflect those considered for design post submission;
- 5) Contractor shall be responsible for the provision of ramp access at any change in road surface and for the provision of traffic cone on a temporary surface, and for pedestrian/cycle ramps where footpath/cycle-ways have a level discontinuity as per result of the works.

Rev	Date	Details	Dm	Chk	App	Dm	DS	Project CLONTARF TO CITY CENTRE PROJECT			
						Chk	SD				
						App	DH				
						Date	20/01/2023				
						Scale	A1 NTS A3 NTS	Title TRAFFIC MANAGEMENT PLAN SECTION 7 TRAFFIC SIGNALS WORKS - STAGE 2			
						Stage	CONSTRUCTION				
								Drawing No	C21020_00_085B	Rev	00