

ISO A1 594mm x 841mm
 Project Management Initials: Designer: TM Checked: AM Approved: BMcM
 Last saved by: CLONIA MURPHY (2022.08.31) Last Plotted: 2022.09.05
 Filename: I:\EU\AECOM\NET\COMEMAI\UK\IEDBL2\UBSPR-230627_FITZWILLIAM_CYCLE_ROUTE_DCC900_CAD_GS910_CAD20-SHEETSDetailed Design\60578028_DD_100_A.DWG

ORDNANCE SURVEY IRELAND LICENCE NO AR0064220
 © ORDNANCE SURVEY IRELAND / GOVERNMENT OF IRELAND

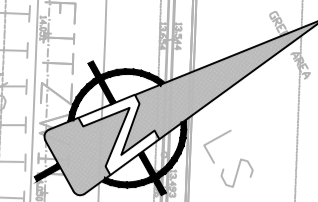

This drawing has been prepared for the use of AECOM's client. It may not be used, modified, reproduced or relied upon by third parties, except as required by law. AECOM accepts no responsibility, and denies any liability, whatsoever, to any party that uses or relies on this drawing without AECOM's express written consent. Do not scale this document. All measurements must be obtained from the stated dimensions.

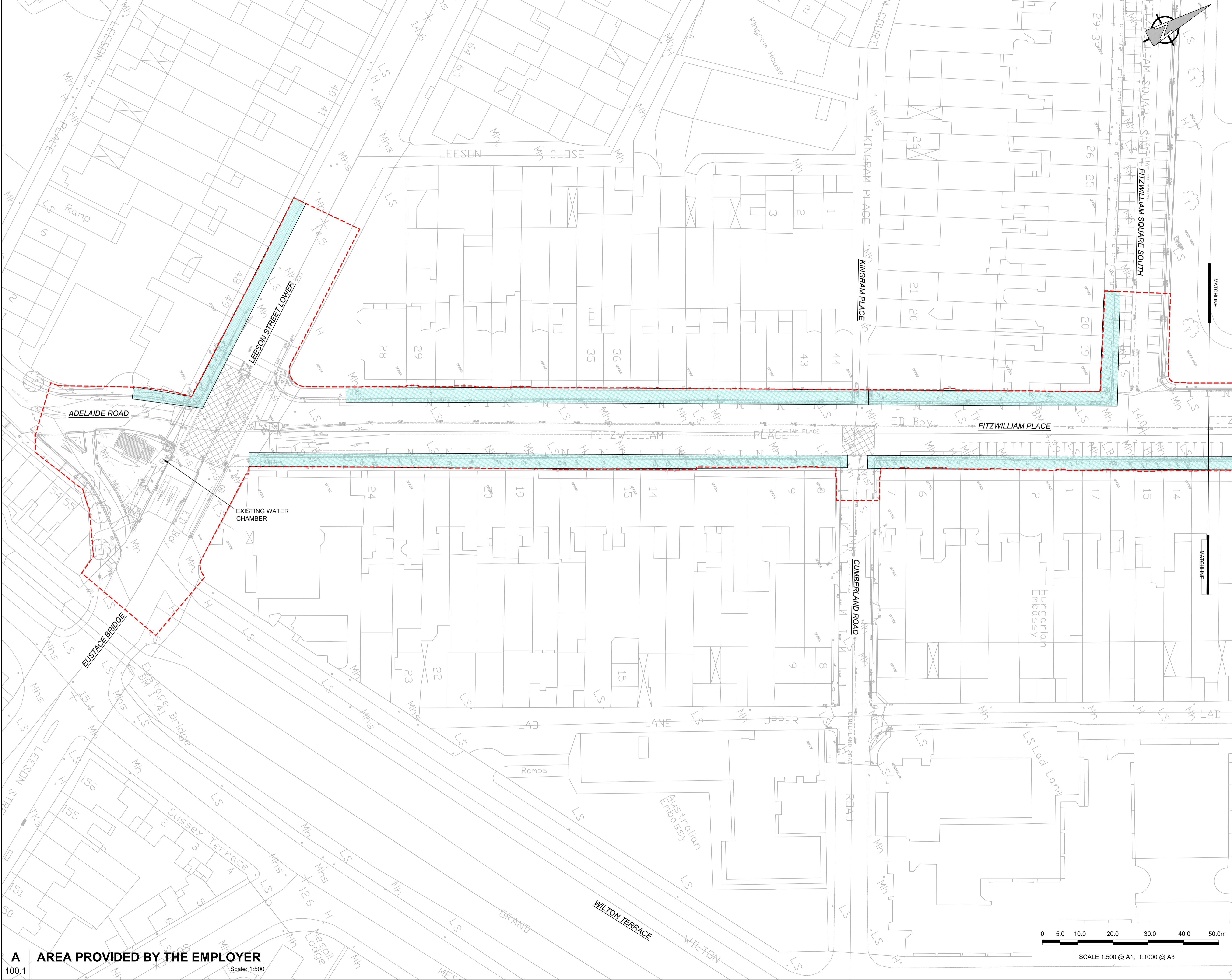

PROJECT
 Fitzwilliam Cycle Route



CONSULTANT
 AECOM
 Adelphi Plaza
 George's Street Upper
 Dun Laoghaire Co. Dublin
 Tel: +353(0)1 2383100 Fax: +353(0)1 2383199
 www.aecom.com

- NOTES:**
- DO NOT SCALE. ALL MEASUREMENTS & CO-ORDINATES TO BE CHECKED ON SITE.
 - LEVELS ARE IN METRES & ARE RELATED TO ORDNANCE SURVEY DATUM MALIN HEAD.
 - ALL DRAWINGS TO BE CHECKED BY THE CONTRACTOR ON SITE.
 - THE LOCATION & DEPTH OF SERVICES TO BE CHECKED ON SITE PRIOR TO COMMENCING ANY WORKS
 - ALL BOUNDARIES AND ADJOINING ROADS TO BE CHECKED ON SITE PRIOR TO CONSTRUCTION.
 - EMPLOYER'S REPRESENTATIVE TO BE INFORMED BY THE CONTRACTOR OF ANY DISCREPANCIES BEFORE ANY WORK COMMENCES.

LEGEND:

- INDICATIVE CELLAR LOCATIONS
- AREA PROVIDED BY EMPLOYER

ISSUE/REVISION

NO.	DATE	DESCRIPTION
A	JUNE 2022	ISSUED FOR TENDER
I/R	DATE	DESCRIPTION

KEY PLAN

PROJECT NUMBER
 60578028
SHEET TITLE
 AREA PROVIDED BY THE EMPLOYER
 SHEET 1 OF 3

SHEET NUMBER
 60578028_DD-SHT-100.1

A AREA PROVIDED BY THE EMPLOYER
 Scale: 1:500

