

LEGEND

- PROPOSED 350mm WIDE LEINSTER GRANITE KERB
350mm WIDE LEINSTER GRANITE KERB TO BE LAID AT A 100mm UPSTAND.
(REFER TO DETAIL "C" ON DRAWING 1101.1 FOR DETAILS)
- PROPOSED CONCRETE PROTECTION KERB
CONCRETE KERB TO BE CONSTRUCTED WITH A 100mm UPSTAND.
WIDTH VARIES. MINIMUM WIDTH 300mm
(REFER TO TII CC-SCD-01102 FOR DETAILS)
- PROPOSED 300mm WIDE LEINSTER GRANITE KERB
300mm WIDE LEINSTER GRANITE KERB TO BE LAID FLUSH WITH CARRIAGEWAY.
(INCLUDING TRANSITIONS). (REFER TO DETAIL "C" ON DRAWING 1101.1 FOR DETAILS)
- PROPOSED 350mm WIDE LEINSTER GRANITE KERB
PROPOSED 350mm WIDE LEINSTER GRANITE KERB TO BE LAID FLUSH WITH CARRIAGEWAY. (INCLUDING TRANSITIONS)
- PROPOSED 300mm WIDE CONCRETE KERB
PROPOSED 300mm WIDE CONCRETE KERB TO BE CONSTRUCTED FLUSH WITH CARRIAGEWAY. (INCLUDING TRANSITIONS)
- ANTIQUE GRANITE KERB 150mm WIDE
RELOCATED TO SUIT ADJACENT FOOTWAY LEVELS
- EXISTING 150mm WIDE GRANITE KERB
EXISTING 150mm WIDE GRANITE KERB TO BE REINSTATED FLUSH WITH CARRIAGEWAY. (INCLUDING TRANSITIONS)
- ANTIQUE GRANITE KERB 150mm WIDE
ADJUSTED TO SUIT ADJACENT FOOTWAY LEVELS.
- EXISTING 300mm WIDE GRANITE KERB
EXISTING 300mm WIDE GRANITE KERB TO BE REINSTATED TO MATCH EXISTING UPSTAND.
- PROPOSED 300mm WIDE LEINSTER GRANITE KERB
300mm WIDE LEINSTER GRANITE KERB TO BE LAID AT A 100mm UPSTAND.
(REFER TO DETAIL "C" ON DRAWING 1101.1 FOR DETAILS)
- ANTIQUE GRANITE KERB 300mm WIDE
ADJUSTED TO SUIT ADJACENT FOOTWAY LEVELS.
- EXISTING GRANITE KERB 300mm WIDE
RELOCATED TO SUIT ADJACENT FOOTWAY LEVELS
- ANTIQUE GRANITE KERB 450mm WIDE
RELOCATED TO SUIT ADJACENT FOOTWAY LEVELS
- ANTIQUE GRANITE KERB 450mm WIDE
ADJUSTED TO SUIT ADJACENT FOOTWAY LEVELS.
- ANTIQUE GRANITE KERB 150mm WIDE
ADJUSTED TO SUIT 0mm TO 6mm UPSTAND (INCLUDING TRANSITIONS)
- ANTIQUE GRANITE KERB 300mm WIDE
RELOCATED WITH A 0mm TO 6mm UPSTAND
- GRANITE KERB 300mm WIDE
TO BE ADJUSTED TO SUIT 0mm TO 6mm UPSTAND ABOVE FINISHED ROAD LEVEL
(INCLUDING TRANSITIONS)
- GRANITE KERB 450mm WIDE
ADJUSTED TO SUIT 0mm TO 6mm UPSTAND (INCLUDING TRANSITIONS)
- PROPOSED 300mm WIDE LEINSTER GRANITE KERB QUADRANT
300mm WIDE LEINSTER GRANITE KERB QUADRANT
- TACTILE PAVING
PROPOSED 400x400x50mm RED BLISTER
TACTILE PAVING CONSTRUCTION AT CONTROLLED CROSSINGS.
(AS PER SECTION 5.5 OF DCC CONSTRUCTION STANDARDS)
- TACTILE PAVING
PROPOSED 400x400x100mm PINK GRANITE BLISTER
TACTILE PAVING CONSTRUCTION AT CONTROLLED CROSSINGS.
(REFER TO DETAIL "H" ON DRAWING 1101.2)
- TACTILE PAVING
PROPOSED 400x400x100mm BLACK GRANITE BLISTER
TACTILE PAVING CONSTRUCTION AT ALL UNCONTROLLED CROSSINGS.
(REFER TO DETAIL "H" ON DRAWING 1101.2)
- PROPOSED CYCLE TRACK RAMP
- PROPOSED CONCRETE FOOTWAY CONSTRUCTION
(REFER TO TII CC-SCD-01105 - Type 1)
- PROPOSED 600x600x63mm CONCRETE PAVING SLABS
(REFER TO DETAIL RM012 OF DCC CONSTRUCTION STANDARDS)
- PROPOSED 600x400x100mm LEINSTER GRANITE FLAGS CONSTRUCTION
(REFER TO DETAIL RM006 OF DCC CONSTRUCTION STANDARDS)
- PROPOSED 100x100x100mm LEINSTER GRANITE SETTS CONSTRUCTION
(REFER TO DETAIL "D" ON DRAWING 1101.1)
- PROPOSED CYCLE / TRAFFIC ISLAND CONSTRUCTION
(REFER TO TII CC-SCD-01110 & CC-SCD-01107)
- PROPOSED ALTERNATING LEINSTER GRANITE FLAGS CONSTRUCTION
500, 400, 300L x 400, 300W x 100mm FLAG
FOR PAVING PATTERN REFER TO DETAIL "D" ON DRAWING 1102.1
FOR CONSTRUCTION DETAIL REFER TO DETAIL "A" ON DRAWING 1101.1)
- PROPOSED ALTERNATING LEINSTER GRANITE FLAGS CONSTRUCTION
500, 400, 300L x 400, 300W x 60mm FLAG
FOR PAVING PATTERN REFER TO DETAIL "D" ON DRAWING 1102.1
FOR CONSTRUCTION DETAIL REFER TO DETAIL "B" ON DRAWING 1101.1)
- PROPOSED PRE-CAST CONCRETE FLAGS CONSTRUCTION
- PROPOSED GREY RESIN BOUND AGGREGATE

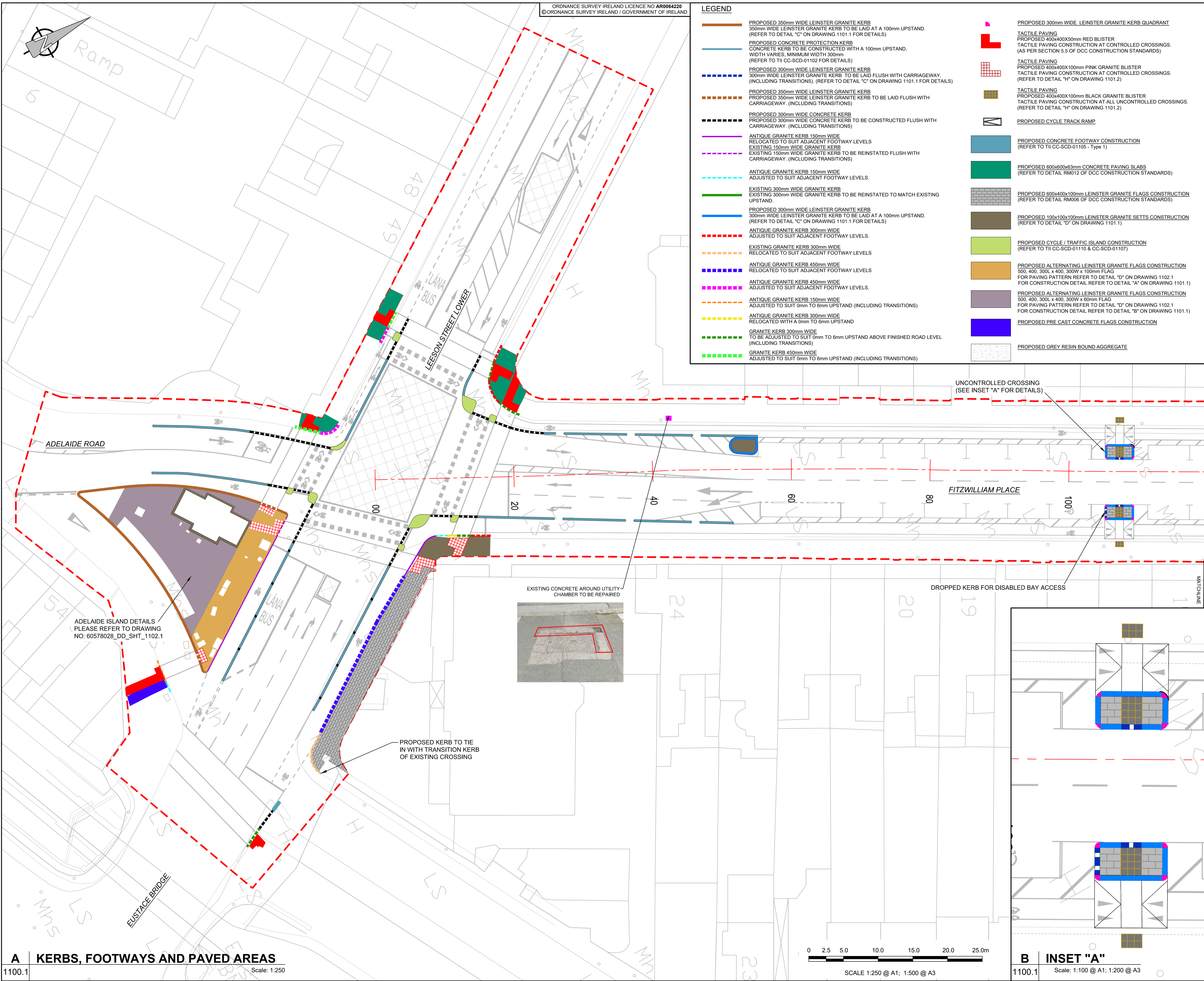

UNCONTROLLED CROSSING
(SEE INSET "A" FOR DETAILS)

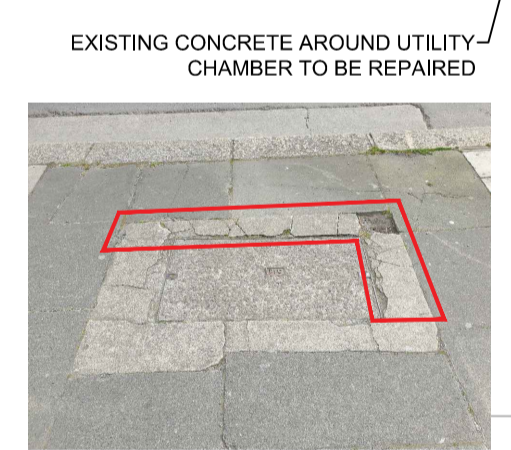

DROPPED KERB FOR DISABLED BAY ACCESS

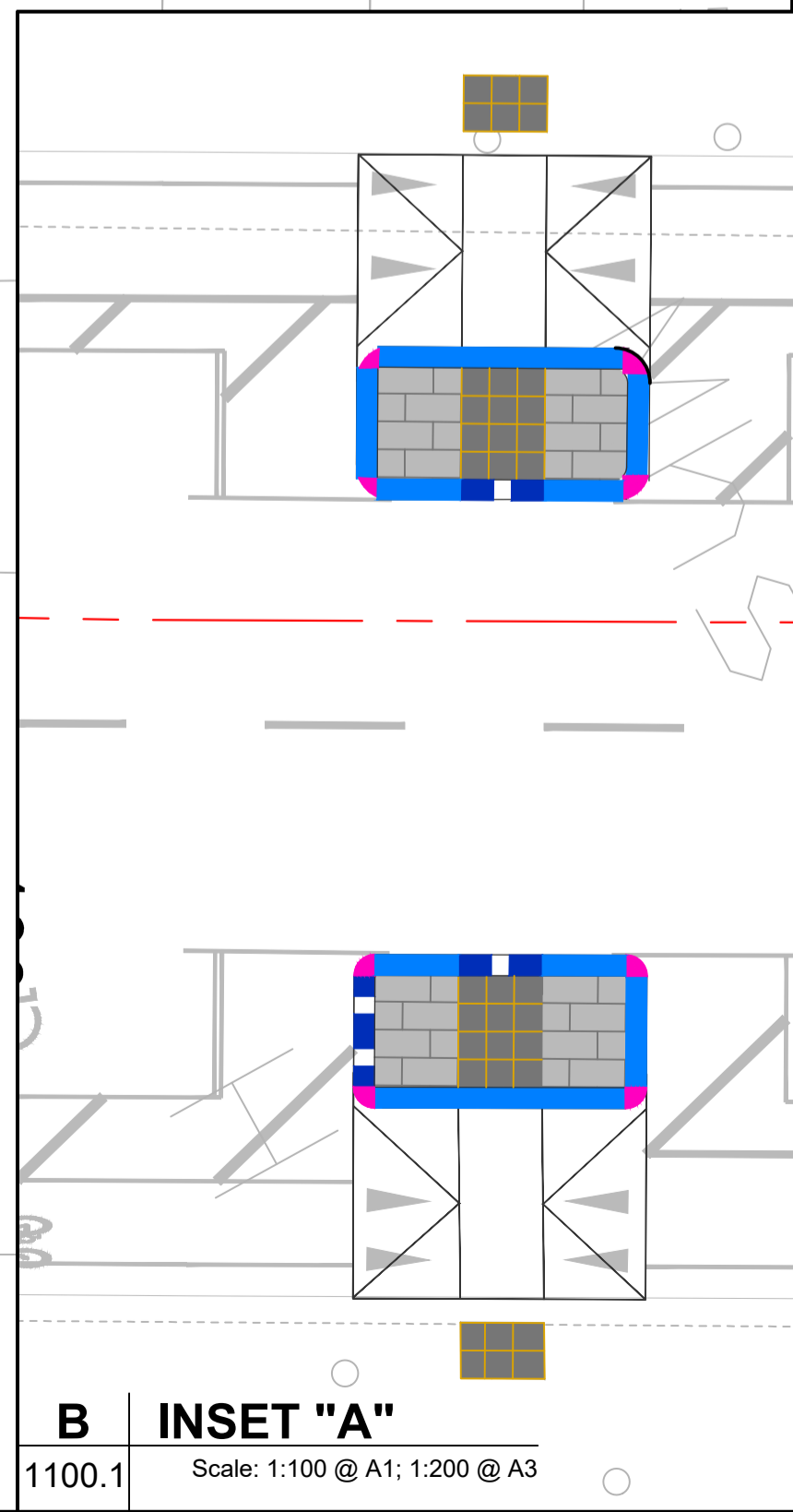

ADELAIDE ISLAND DETAILS
PLEASE REFER TO DRAWING
NO: 60578028_DD_SHT_1102.1

AECOM

PROJECT
Fitzwilliam Cycle Route

CLIENT
Comhairle Cathrach
Bhaile Átha Cliath
Dublin City Council

NTA
Údarás Náisiúnta Iompair
National Transport Authority

Project Ireland 2040
Building Ireland's Future

CONSULTANT
AECOM
Adelphi Plaza
George's Street Upper
Dun Laoghaire Co.Dublin
Tel:+353(0)1 2383100 Fax:+353(0)1 2383199
www.aecom.com

NOTES:

- THIS DRAWING IS TO BE READ IN CONJUNCTION WITH ALL OTHER RELEVANT ARCHITECTURAL AND ENGINEERING DRAWINGS. ANY DISCREPANCIES, ERRORS OR OMISSIONS TO BE BROUGHT TO THE ATTENTION OF THE DESIGNER.
- ALL DIMENSIONS TO BE CHECKED BY THE CONTRACTOR ON SITE PRIOR TO COMMENCEMENT OF WORKS.
- DO NOT SCALE. ALL MEASUREMENTS AND COORDINATES TO BE CHECKED ON SITE.
- CONTRACTOR TO REFER TO SPECIFICATION APPENDIX 11/1 FOR ADDITIONAL DETAILS.
- CONTRACTOR TO UNDERTAKE WORKS TO KERBS, FLAGSTONES AND SETTS IN ACCORDANCE WITH THE "CONSTRUCTION STANDARDS FOR ROAD AND STREET WORKS IN DUBLIN CITY COUNCIL".
- WHERE CHAMBERS ARE LOCATED IN PAVED AREAS, THE PAVING SHOULD BE FINISHED TO WITHIN 5MM OF THE FRAME.

ISSUE/REVISION

I/R	DATE	DESCRIPTION
A	JUNE 2022	ISSUED FOR TENDER

KEY PLAN

PROJECT NUMBER
60578028

SHEET TITLE
KERBS, FOOTWAYS AND PAVED AREAS
SHEET 1 OF 6

SHEET NUMBER
60578028_DD_SHT_1100.1

This drawing has been prepared for the use of AECOM's client. It may not be used, modified, reproduced or relied upon by third parties, except as agreed by AECOM, or as required by law. AECOM accepts no responsibility, and denies any liability, whatsoever, to any party that uses or relies on this drawing without AECOM's express written consent. All measurements must be obtained from the stated dimensions.