

SCHEDULE OF ROAD MARKINGS

REF No.	LENGTH OF LINE (m)	LENGTH OF GAP (m)	WIDTH OF LINE (m)	CLOUR	KEY
RRM 001	CONTINUOUS	N/A	0.10	WHITE	
RRM 002B	3.0	3.0	0.10	WHITE	
RRM 003B	2.0	2.0	0.10	WHITE	
RRM 004	LANE INDICATION ARROWS AS PER FIG. 7.24 DOE TRAFFIC SIGNS MANUAL 2010				
RRM 005	LANE INDICATION ARROWS AS PER FIG. 7.24 DOE TRAFFIC SIGNS MANUAL 2010				
RRM 006	LANE INDICATION ARROWS AS PER FIG. 7.24 DOE TRAFFIC SIGNS MANUAL 2010				
RRM 008	CONTINUOUS	N/A	0.10	YELLOW	
RRM 009	LOADING BAY MARKINGS AS PER 7.6.14 DOT TRAFFIC SIGNS MANUAL 2010				
RRM 011	PARALLEL PARKING BAYS AS PER 7.6.6 DOT TRAFFIC SIGNS MANUAL 2010				
RRM 013	PERPENDICULAR PARKING BAYS AS PER 7.6.9 DOT TRAFFIC SIGNS MANUAL 2010				
RRM 015	DISABLED PERSONS' PARKING AS PER 7.6.10 DOT TRAFFIC SIGNS MANUAL 2010				
RRM 016	PARALLEL PARKING BAYS AS PER 7.6.6 DOT TRAFFIC SIGNS MANUAL 2010				
RRM 017	CONTINUOUS	N/A	0.20	WHITE	
RRM 018C	DASHED	N/A	0.10	WHITE	
RRM 019	CONTINUOUS	N/A	0.20	WHITE	
RRM 020	YELLOW BOX MARKING AS PER DOT TRAFFIC SIGNS MANUAL 2010				
RRM 021	HATCH MARKING AS PER FIG. 7.18 DOT TRAFFIC SIGNS MANUAL 2010				
RRM 022	CONTINUOUS	N/A	0.10	WHITE	
RRM 023	0.75	7.5	0.10	WHITE	
RRM 024	CONTINUOUS	N/A	0.25	WHITE	
RRM 024	WORDED LANA BUS MARKING AS PER TRAFFIC SIGNS MANUAL 2010				
RRM 029	TAXI STAND MARKINGS AS PER 7.6.13 TRAFFIC SIGNS MANUAL 2010				
RRM 030	BUS STOP MARKINGS AS PER 7.7.1 TRAFFIC SIGNS MANUAL 2010				
M 100	DEFLECTION ARROW AS PER TRAFFIC SIGNS MANUAL 2010				
M 101	DEFLECTION ARROW AS PER TRAFFIC SIGNS MANUAL 2010				
M 102	BIFURCATION (8m) ARROW AS PER TRAFFIC SIGNS MANUAL 2010				
M 112	TRAFFIC CALMING TRIANGLE AS PER SECTION 7.17 DOT TRAFFIC SIGNS MANUAL 2010				
M 114	STOP MARKING AS PER SECTION 7.5 DOT TRAFFIC SIGNS MANUAL 2010				
M 115	TRIANGULAR YIELD MARKING AS PER SECTION 7.5 DOT TRAFFIC SIGNS MANUAL 2010				
M 115C	CYCLE TRACK YIELD AS PER SECTION 7.8 DOT TRAFFIC SIGNS MANUAL 2010				
M 116	CYCLE SYMBOL AS PER SECTION 7.8 DOT TRAFFIC SIGNS MANUAL 2010				
M 118	LANE DESTINATION AS PER CHAPTER 7.8 DOT TRAFFIC SIGNS MANUAL 2010				
M 119	LANE DESTINATION AS PER CHAPTER 7.8 DOT TRAFFIC SIGNS MANUAL 2010				
M 124	LANE INDICATION ARROWS AS PER FIG. 7.24 DOE TRAFFIC SIGNS MANUAL 2010				
M 125	LANE INDICATION ARROWS AS PER FIG. 7.24 DOE TRAFFIC SIGNS MANUAL 2010				
M 129	1.0	1.0	0.25	WHITE	
M 130L	LEFT TURN VARIANT OF BUS LANE ENDS ARROW AS PER CHAPTER 7.7 DOT TRAFFIC SIGNS MANUAL 2010				
M 131	CONTINUOUS	N/A	0.15	WHITE	
ACM 001	SHARROW MARKING. PLEASE REFER TO STANDARD DETAIL AECCD_1264				
ACM 002	ELEPHANT FOOTPRINTS. PLEASE REFER TO STANDARD DETAIL AECCD_1265				
EXISTING ROAD MARKING TO BE REMOVED					

ORDNANCE SURVEY IRELAND LICENCE NO AR0064220
©ORDNANCE SURVEY IRELAND / GOVERNMENT OF IRELAND

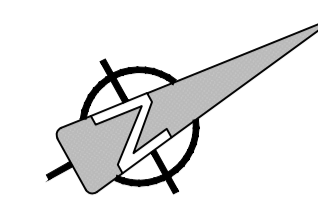

PROJECT
Fitzwilliam Cycle Route



CONSULTANT
AECOM
Adelphi Plaza
George's Street Upper
Dun Laoghaire Co.Dublin
Tel:+353(0)1 2383100 Fax:+353(0)1 2383199
www.aecom.com

- NOTES:
- LEVELS ARE IN METRES & ARE RELATED TO ORDNANCE DATUM.
 - SETTING OUT DETAILS TO BE AGREED WITH EMPLOYER'S REPRESENTATIVE.
 - ALL ROAD MARKINGS & SIGNAGE TO BE IN ACCORDANCE WITH TRAFFIC SIGNS MANUAL.
 - ALL SIGNS TO BE INSTALLED ON A CRANKED POLE TO THE BACK OF FOOTPATH UNLESS OTHERWISE AGREED WITH ENGINEERS REPRESENTATIVE.
 - TRAFFIC SIGNS TO BE INSTALLED IN SUCH A WAY AS TO ENSURE A LATERAL CLEARANCE OF 0.45m DISTANCE FROM THE OUTSIDE EDGE OF THE SIGN FACE TO THE ROADSIDE KERB.
 - ALL TRAFFIC SIGNS TO BE MOUNTED ON POLES TO ENSURE A MINIMUM HEAD CLEARANCE OF 2.5m UNLESS SPECIFIED OTHERWISE.
 - REFER TO SPECIFICATION APPENDICES 12/1 AND 12/3.

ISSUE/REVISION

NO.	DATE	DESCRIPTION
A	JUNE 2022	ISSUED FOR TENDER
I/R	DATE	DESCRIPTION

KEY PLAN

PROJECT NUMBER
60578028

SHEET TITLE
TRAFFIC SIGNS AND ROAD MARKINGS SHEET 5 OF 6

SHEET NUMBER
60578028_DD_SHT-1200.5

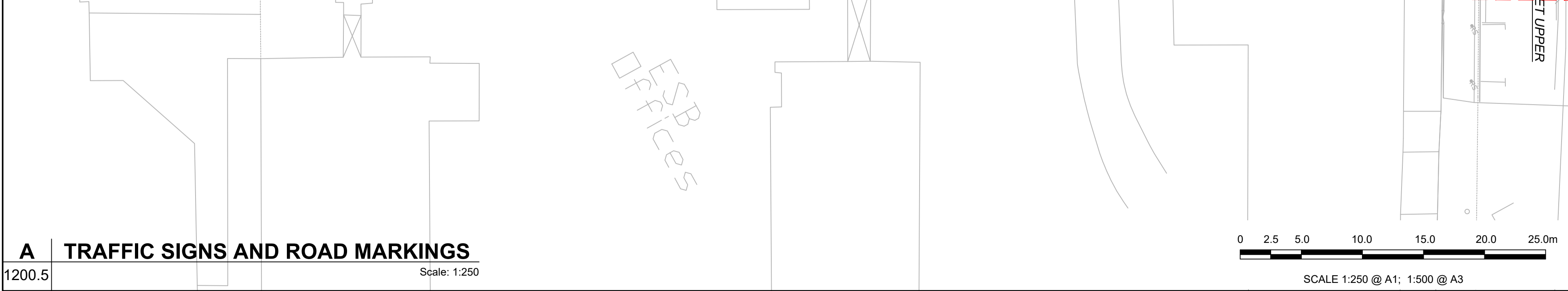
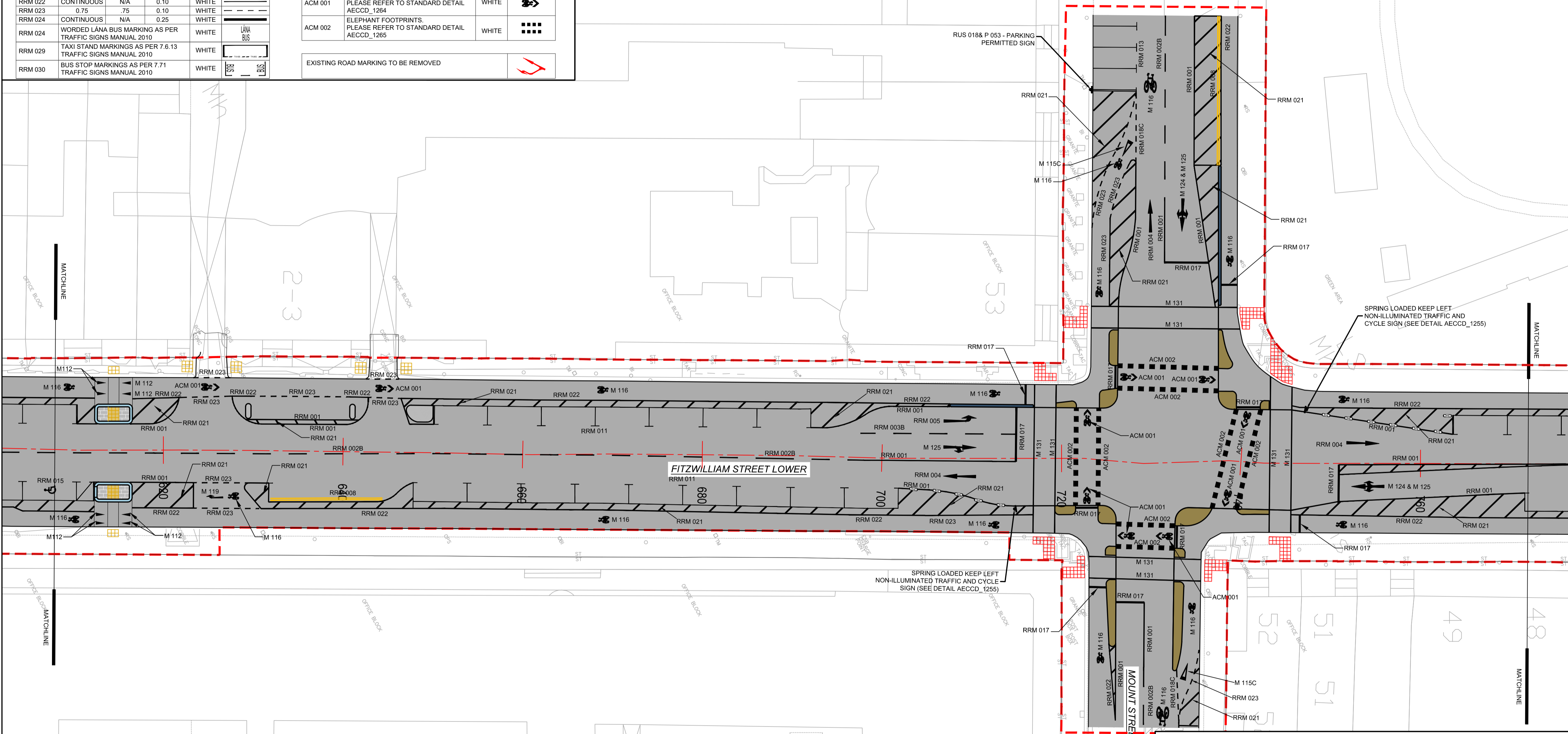

A TRAFFIC SIGNS AND ROAD MARKINGS

2200.5 Scale: 1:250

This drawing has been prepared for the use of AECOM's client. It may not be used, modified, reproduced or relied upon by third parties, except as agreed by AECOM or as required by law. AECOM accepts no responsibility, and denies any liability, whatsoever, to any party that uses or relies on this drawing without AECOM's express written consent. All measurements must be obtained from the stated dimensions.