

Last saved by: MEHANT(2022_08_18) Last Plot: 2022_09_05
 Filename: I:\EU\AECOM\NET\COMEM\UK\IED\DL2\UBSPR-298627_FITZWILLIAM_CYCLE_ROUTE_DCC900_CAD_GS910_CAD20-SHEETS\DETAILED DESIGN\60578028_DD_900.4 TO 900.6_A.DWG
 Project Management Initials: Designer: TM Checked: AM Approved: BMcM ISO A1 594mm x 841mm

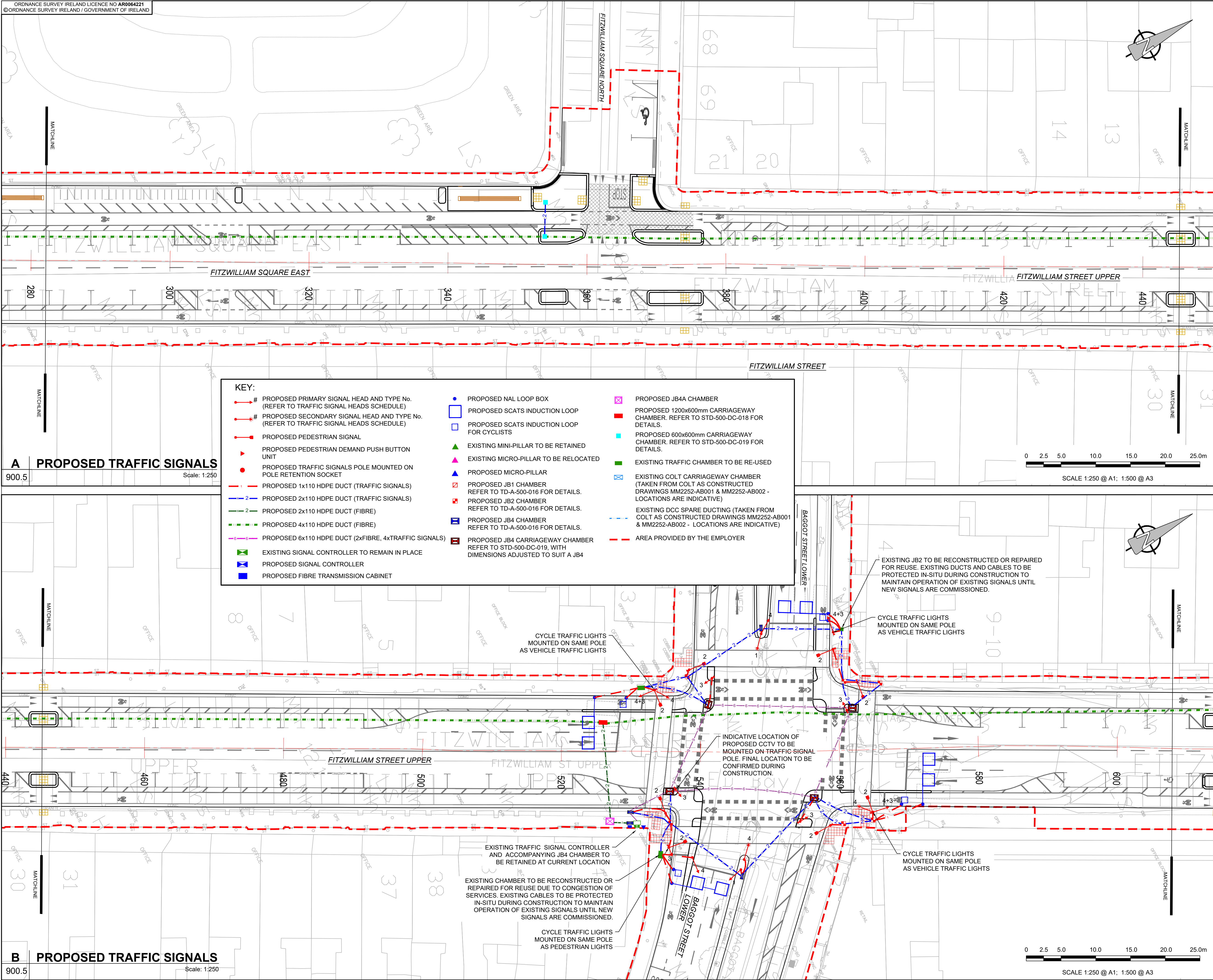

A PROPOSED TRAFFIC SIGNALS
Scale: 1:250

KEY:

<ul style="list-style-type: none"> ➤ # PROPOSED PRIMARY SIGNAL HEAD AND TYPE No. (REFER TO TRAFFIC SIGNAL HEADS SCHEDULE) ➤ # PROPOSED SECONDARY SIGNAL HEAD AND TYPE No. (REFER TO TRAFFIC SIGNAL HEADS SCHEDULE) ➤ PROPOSED PEDESTRIAN SIGNAL ➤ PROPOSED PEDESTRIAN DEMAND PUSH BUTTON UNIT ➤ PROPOSED TRAFFIC SIGNALS POLE MOUNTED ON POLE RETENTION SOCKET — 1 — PROPOSED 1x110 HDPE DUCT (TRAFFIC SIGNALS) — 2 — PROPOSED 2x110 HDPE DUCT (TRAFFIC SIGNALS) — 2 — PROPOSED 2x110 HDPE DUCT (FIBRE) — 4 — PROPOSED 4x110 HDPE DUCT (FIBRE) — 6 — PROPOSED 6x110 HDPE DUCT (2xFIBRE, 4xTRAFFIC SIGNALS) ⊠ EXISTING SIGNAL CONTROLLER TO REMAIN IN PLACE ⊠ PROPOSED SIGNAL CONTROLLER ⊠ PROPOSED FIBRE TRANSMISSION CABINET 	<ul style="list-style-type: none"> ● PROPOSED NAL LOOP BOX □ PROPOSED SCATS INDUCTION LOOP □ PROPOSED SCATS INDUCTION LOOP FOR CYCLISTS ▲ EXISTING MINI-PILLAR TO BE RETAINED ▲ EXISTING MICRO-PILLAR TO BE RELOCATED ▲ PROPOSED MICRO-PILLAR ⊠ PROPOSED JB1 CHAMBER REFER TO TD-A-500-016 FOR DETAILS. ⊠ PROPOSED JB2 CHAMBER REFER TO TD-A-500-016 FOR DETAILS. ⊠ PROPOSED JB4 CHAMBER REFER TO TD-A-500-016 FOR DETAILS. ⊠ PROPOSED JB4 CARRIAGEWAY CHAMBER REFER TO STD-500-DC-019, WITH DIMENSIONS ADJUSTED TO SUIT A JB4 	<ul style="list-style-type: none"> ⊠ PROPOSED JB4A CHAMBER ⊠ PROPOSED 1200x600mm CARRIAGEWAY CHAMBER. REFER TO STD-500-DC-018 FOR DETAILS. ⊠ PROPOSED 600x600mm CARRIAGEWAY CHAMBER. REFER TO STD-500-DC-019 FOR DETAILS. ⊠ EXISTING TRAFFIC CHAMBER TO BE RE-USED ⊠ EXISTING COLT CARRIAGEWAY CHAMBER (TAKEN FROM COLT AS CONSTRUCTED DRAWINGS MM2252-AB001 & MM2252-AB002 - LOCATIONS ARE INDICATIVE) ⊠ EXISTING DCC SPARE DUCTING (TAKEN FROM COLT AS CONSTRUCTED DRAWINGS MM2252-AB001 & MM2252-AB002 - LOCATIONS ARE INDICATIVE) — — AREA PROVIDED BY THE EMPLOYER
--	--	--

B PROPOSED TRAFFIC SIGNALS
Scale: 1:250

AECOM

PROJECT
Fitzwilliam Cycle Route

CLIENT
Comhairle Cathrach
Bhaile Átha Cliath
Dublin City Council

NTA
Údarás Náisiúnta Iompair
National Transport Authority

Project Ireland 2040
Building Ireland's Future

CONSULTANT
AECOM
Adelphi Plaza
George's Street Upper
Dun Laoghaire Co. Dublin
Tel: +353(0)1 2383100 Fax: +353(0)1 2383199
www.aecom.com

- TRAFFIC SIGNALS NOTES:**
- TRAFFIC SIGNAL DUCTS (CONTINUOUS LINE) ARE SMOOTH BORE 100MM DIA. HDPE (RED, MARKED 'TRAFFIC') EXCEPT WHEN DETAILED OTHERWISE. NUMBER OF DUCTS BETWEEN CHAMBERS IS INDICATED ADJACENT TO THAT DUCT RUN WITH A NUMBER.
 - TRAFFIC SIGNAL CONTROLLER TO BE SCATS COMPLIANT.
 - PLEASE REFER TO APPENDIX 12/5 OF THE SPECIFICATION FOR FURTHER DETAILS.
 - FOR SIGNAL HEAD CONFIGURATIONS, REFER TO APPENDIX 9A TRAFFIC SIGNALS MANUAL 2019.
 - FIBRE DUCTS (CONTINUOUS LINE) ARE SMOOTH BORE 100MM DIA. HDPE (GREEN, MARKED 'FIBRE') EXCEPT WHEN DETAILED OTHERWISE. NUMBER OF DUCTS BETWEEN CHAMBERS IS INDICATED ADJACENT TO THAT DUCT RUN WITH A NUMBER.
 - POSITION OF DUCTING, CHAMBERS, POLES AND INDUCTION LOOPS TO BE AGREED WITH SIGNALS CONTRACTOR, DCC TRAFFIC OFFICERS, AND EMPLOYER'S REPRESENTATIVE.
 - EXISTING TRAFFIC SIGNALS TO REMAIN OPERATIONAL UNTIL NEW SIGNALS ARE COMMISSIONED. EXISTING SIGNAL CABLES TO BE PROTECTED DURING THE WORKS.
 - TRAFFIC SIGNALS TO BE INSTALLED TO PROVIDE A MINIMUM LATERAL CLEARANCE OF 450MM FROM THE ADJACENT CARRIAGEWAY / CYCLEWAY EDGE. PUSH BUTTON UNITS TO BE INSTALLED WITHIN 500MM OF THE EDGE OF TACTILE PAVING.
 - DUE TO THE PRESENCE OF EXISTING SERVICES AND CELLARS, ONLY HAND-DIGGING WILL BE PERMITTED.

ISSUE/REVISION

I/R	DATE	DESCRIPTION
A	JUNE 2022	ISSUED FOR TENDER

KEY PLAN

PROJECT NUMBER
60578028

SHEET TITLE
PROPOSED TRAFFIC SIGNALS
SHEET 2 OF 3

SHEET NUMBER
60578028_DD-SHT_900.5

This drawing has been prepared for the use of AECOM's client. It may not be used, modified, reproduced or relied upon by third parties, except as agreed by AECOM or as required by law. AECOM accepts no responsibility, and denies any liability, whatsoever, to any party that uses or relies on this drawing without AECOM's express written consent. Do not scale this document. All measurements must be obtained from the scaled dimensions.