

CLONTARF TO CITY CENTRE PROJECT
SECTION 3 - ROAD CONSTRUCTION
CH1200 - 1360

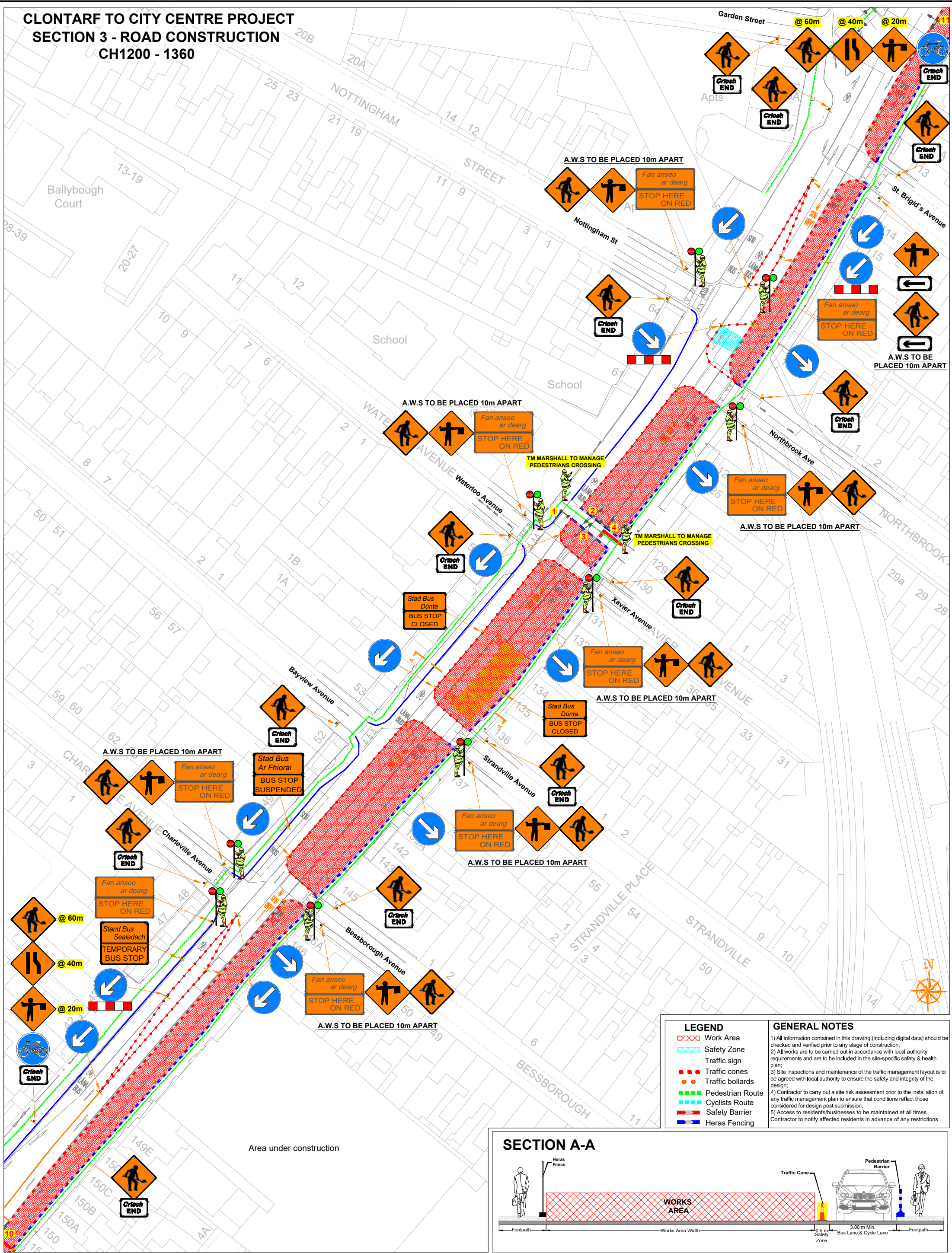

ROAD CONTROL

Copyright Notes:
This drawing is the property of Road Control Services Ltd. The design information contained herein is strictly confidential. This document is not to be used, reproduced, disclosed or circulated in whole or in part without prior written consent.

CLIENT

CLONMEL ENTERPRISES
BUILDING & CIVIL ENGINEERING

DESIGN PARAMETERS

Speed Limit	60	Sign size (diamond)	600mm
Road Classification	1(IV)	Sign size (circular)	600mm
Roadworks type	B	Minimum Cone size	750mm
Number of advance signs	3	Cone spacing at tapers	3m
Sign visibility	60m	Cone spacing longitudinal	6m
Distance between signs	20m	Lateral Safety Zone	0.5m
Taper at lane	1 in 10 / 45°	Longitudinal Safety Zone	15m
Taper at hard shoulder	N/A	Minimum lane width	3.0m

Rev	Date	Details	Drm	Chk	App	Drm	Chk	App	DS
01	14.03.23	BUS STOP RELOCATION	DS	MA	DH				MA
									DH
									02/03/2022
									A1 NTS
									A3 NTS
									CONSTRUCTION

Project: **CLONTARF TO CITY CENTRE PROJECT**

Title: **TRAFFIC MANAGEMENT PLAN SECTION 3 ROAD CONSTRUCTION CH1200 - 1360**

Drawing No: **C22001_00_104B** Rev: **1**