

The Liffey Cycle Route

Georges Quay to Aston Quay Section

INFORMATION LEAFLET

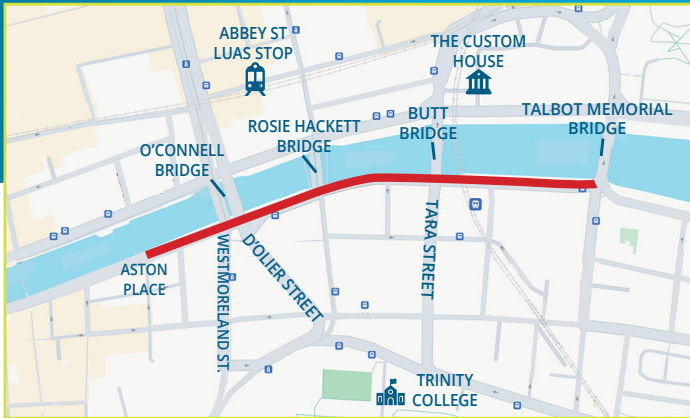
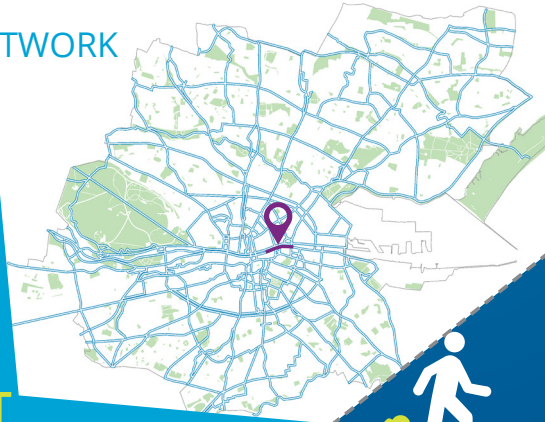

WHAT'S IN THIS LEAFLET?

- 1 Project Overview
- 2 Photomontages
- 3 Contact Details
- 4 Further Updates

The Georges Quay to Aston Quay section of the Liffey Cycle Route is part of Dublin City Council's (DCC) Active Travel Network. This scheme will upgrade the existing road layout, improving walking and cycling facilities. It will also provide safer crossing points from Talbot Memorial Bridge to Aston Place on Aston Quay.

Construction of the project is due to commence in March 2024 and be completed before the end of Q2 2025. In order to deliver this complex but worthwhile project, there will be some unavoidable temporary disruption to the area. DCC, in collaboration with our contractor will endeavour to minimise this as much as possible.

TIMELINE



October 2023

Tenders
Advertised

December 2023

Contractor
Appointed

March 2024

Construction
Start

Q2 2025

Construction
Complete



Tionscadal Éireannach
Project Ireland
2040



NTA
Udarás Náisiúnta Iompair
National Transport Authority



Comhairle Cathrach
Bhaile Átha Cliath
Dublin City Council

1 PROJECT OVERVIEW

The Liffey Cycle Route - Georges Quay to Aston Quay section will:

- Provide improved segregated two-way cycle facilities from Talbot Bridge to O'Connell Bridge
- Improve crossing facilities for cyclists and pedestrians
- Reduce number of traffic lanes from two to one, while maintaining the bus lane (see Section 2 - Photomontages)
- Improve carriageway surface
- Encourage walking and cycling in the area by providing improved facilities
- Contribute to a reduction in transport emissions in line with the objectives of the Climate Action Plan by encouraging a modal shift to active travel and public transport use

TALBOT BRIDGE, GEORGES QUAY, CITY QUAY JUNCTION

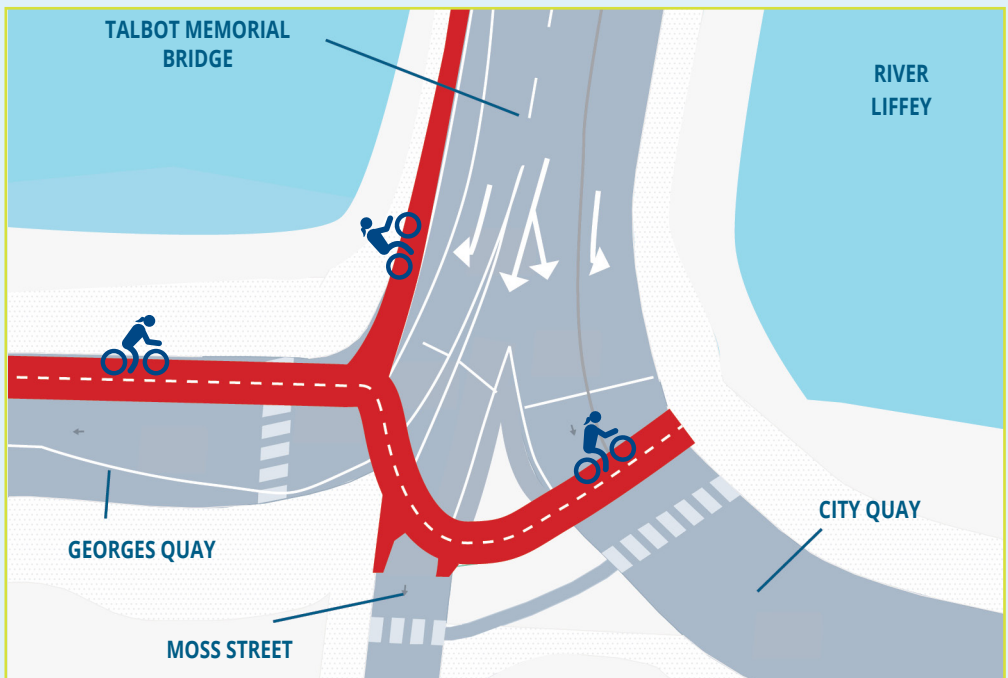



3 HOW TO CONTACT US

If you would like further information on the Liffey Cycle Route project or to contact us, please see the options below:



www.dublincity.ie/residential/transportation/active-travel/projects/liffey-cycle-route

(Scan me)

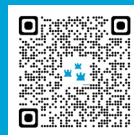

activetraveloffice@dublincity.ie with subject 'Liffey Cycle Route'



Active Travel Programme Office, Dublin City Council, Cavendish House, Block D, Arran Court, Arran Quay, Dublin 7, D07 H5CH



Active Travel Programme Office: 01 222 2536

To contact the contractor, Cairn Construction:



24 Hour Emergency Contact: 087 235 0529



info@cairn.ie



www.cairn.ie

(Scan me)



Courtyard, Behan Square, Russell Street, Dublin 1

4 FURTHER UPDATES

Design drawings for the Scheme are available for viewing at:

- Dublin City Council, Block 1, Floor 0, Civic Offices, Wood Quay, Dublin 8, D08 RF3F
- Central Library, Ilac Centre, Henry Street, Dublin 1, D01 DY80
- Pearse Street Library, 144 Pearse St, Dublin 2, D02 HE37
- www.dublincity.ie/LiffeyCycleRoute