

RANELAGH AVENUE

53.3251, -6.2549

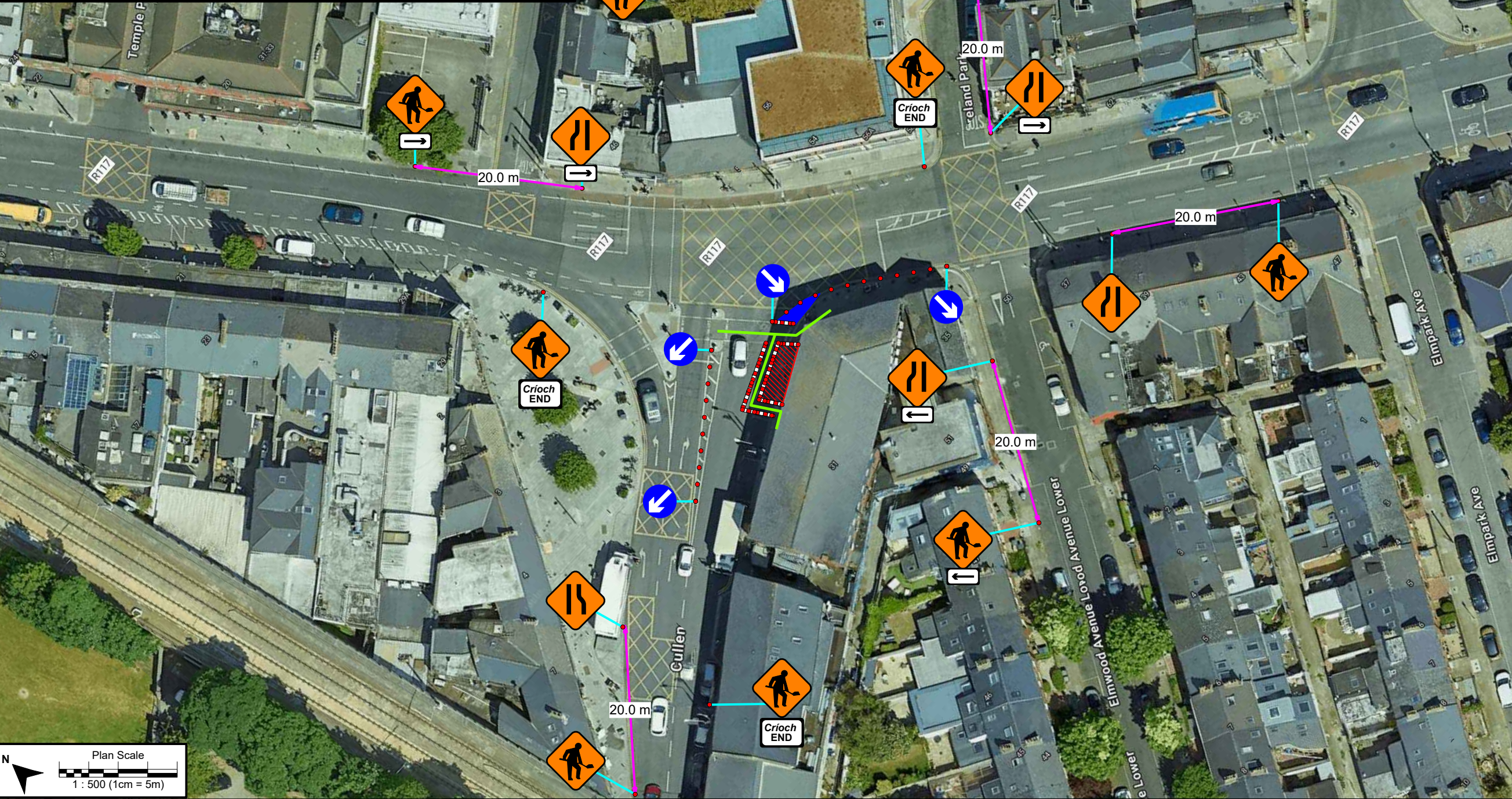

DESIGN PARAMETERS				
ROAD LEVEL:		LEVEL 1(iii)		
ROADWORKS TYPE:		TYPE A		
SPEED LIMIT:		50 km/h		
TEMPORARY SIGNS				
SIGN VISIBILITY:		50M		
NUMBER OF SIGNS:		2		
ADVANCE SIGN SPACING:		20M		
MINIMUM SIGN SIZE:		600mm		
RATE OF TAPER				
TAPER AT LANE:		1 IN 5		
TAPER AT HARD SHOULDER:		N/A		
TRANSITION LENGTH:		N/A		
SAFETY ZONE				
LONGITUDINAL:		5.0M		
LATERAL:		0.5M		
MINIMUM CONE SPACING				
AT TAPER:		3M		
LONGITUDINAL:		3M		
LAMP SPACING DURING HOURS OF DARKNESS				
AT TAPER:		6M		
LONGITUDINAL:		6M		
MIN LANE WIDTH:		3.0M		
DESIGN				
METHOD:		ROAD NARROWS		
Legend				
<div><div><div><div></div></div><div>Barrier</div></div><div><div><div></div></div><div>Cone</div></div><div><div><div></div></div><div>Pedestrians</div></div><div><div><div></div></div><div>Safety Zone</div></div><div><div><div></div></div><div>Work Area</div></div></div>				
<div><div><div><div>Richard Nolan</div><div>civil engineering</div></div><div><div>RN</div><div>CE</div></div></div></div>				
<div><div><div><div>ISO 9001:2015</div><div>QUALITY ASSURED COMPANY</div></div><div><div>ISO 14001:2015</div><div>ENVIRONMENTAL APPROVAL SYSTEM</div></div><div><div>OHSAS 18001:2007</div><div>OCCUPATIONAL HEALTH & SAFETY APPROVED SYSTEM</div></div></div></div>				
Client: DCC				
Project: RANELAGH AVENUE				
Title: NEW KERB				
Director: DN		Proj. Man: PG		Checked: PG
Scale: 1 : 500		Drafted by: MC		Date: 17/10/2024
Drawing No: 99999 - TMP 002				
REV:	DESCRIPTION:	By:	Check:	Date:
000	INITIAL ISSUE	MC	PG	17/10/2024

GENERAL NOTES:

1) THIS TRAFFIC MANAGEMENT PLAN MAY ONLY BE IMPLEMENTED BY A TEMPORARY TRAFFIC OPERATIONS SUPERVISOR WHO MUST CARRY OUT A SITE RISK ASSESSMENT TO MODIFY THE MEASURES DESCRIBED TO SUIT ACTUAL SITE CONDITIONS BEFORE IMPLEMENTATION

2) THE TEMPORARY TRAFFIC OPERATIONS SUPERVISOR MUST BE IN POSSESSION OF THE VALID CONSTRUCTION SKILLS REGISTRATION CARD 'SIGNING, LIGHTING, AND GUARDING AT ROADWORKS' CONSTRUCTION REGULATIONS 2006.

3) THIS TRAFFIC MANAGEMENT PLAN HAS BEEN DRAFTED ON A PRELIMINARY BASIS AND DOES NOT TAKE ACCOUNT OF THE SCALES ASSOCIATED WITH THE DIFFERENT PHASES OF THE PROJECT. ARRANGEMENTS FOR MATERIAL DELIVERY, SPOIL REMOVAL, AND TEMPORARY ACCESS HAVE NOT BEEN DEVELOPED INTO THE PLAN AS THEY WERE NOT ADVISED AT THE TIME OF PREPARATION.

4) IN ORDER THAT THE REQUIREMENTS AS SET PER SECTION 17(2) 2005 ACT ARE SATISFIED, FURTHER ALTERATION TO THE PLAN MUST BE ADVISED BY THE PSPD AS PER CONSTRUCTION REGULATIONS 2006 PS 5 REGS 16-17 AND REG 97 (2a & 2b) RESPECTIVELY. IN ADDITION THE PCS SHOULD FURTHER DIRECT ANY CHANGES AS THE PROJECT PROGRESSES.

5) ALL WORKS ARE TO BE CARRIED OUT IN ACCORDANCE WITH LOCAL AUTHORITY REQUIREMENTS AND TO BE INCLUDED IN THE SITE SPECIFIC SAFETY & HEALTH PLAN.

6) SITE INSPECTIONS AND MAINTENANCE OF THE TRAFFIC MANAGEMENT LAYOUT IS TO BE CONDUCTED ON A DAILY BASIS TO ENSURE THE SAFETY AND INTEGRITY OF THE DESIGN.

7) CONTRACTOR TO CARRY OUT A SITE RISK ASSESSMENT PRIOR TO THE INSTALLATION OF THE TRAFFIC MANAGEMENT PLAN TO ENSURE THAT CONDITIONS REFLECT THOSE CONSIDERED FOR DESIGN POST SUBMISSION.

8) ALL SIGNS USED (AND MANUFACTURED AFTER 01.09.19) MUST CONFORM TO THOSE SPECIFIED IN THE TRAFFIC MANAGEMENT PLAN SO FAR AS THEY ALSO CONFORM TO THE CHAPTER 8 2019. THE SIGNAGE THEREFORE MUST INCORPORATE MICRO PRISMATIC RETROREFLECTIVE SHEETING

9) WK 052

WILL BE USED WHEN A DESIGNATED WORKS ACCESS IS REQUIRED. REFER TO CHAPTER 8 2019 FOR USAGE.

Section

Notes:

PEDESTRIANS WILL BE MONITORED AND CONTROLLED DURING THESE WORKS.

ACCESS AND EGRESS TO BE ACCOMMODATED DURING THESE WORKS.

CAR PARKING SPACES WILL BE SUSPENDED DURING THESE WORKS.

WORK IS CARRIED OUT WITHIN 30 METERS OF A TRAFFIC LIGHTS, CONTACT THE DCC ROAD

AT NO TIME SHOULD ANY PLANT BE PARKED UP NEAR THE TRAFFIC LIGHTS, IN ORDER TO AVOID OBSTRUCTING TRAFFIC LIGHT VISIBILITY.